

BASE CONDUIT

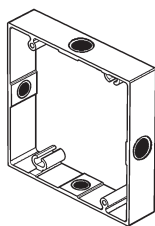

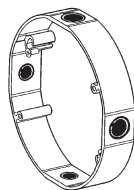



XA05

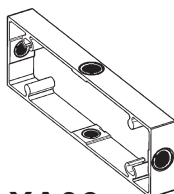

XA04

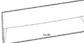

XA06

	ART.		
	Ø 200	644B	XA04
	▣ 180	645B	XA05
	▣ 270 x 90	646B	XA06

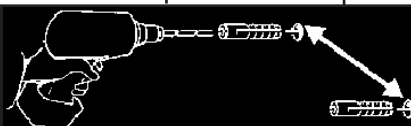

FRONT VIEW

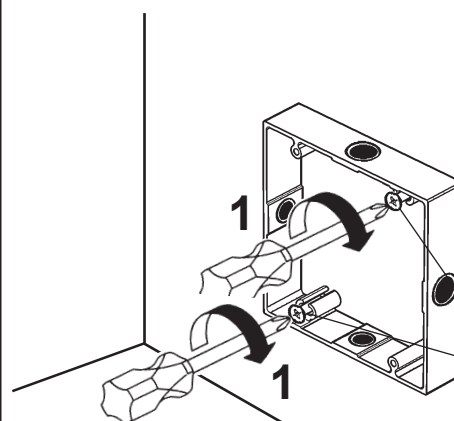
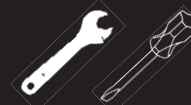
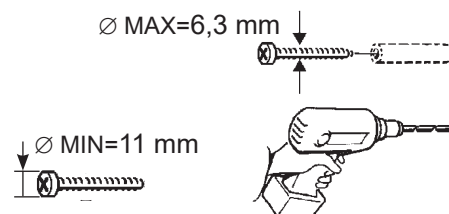
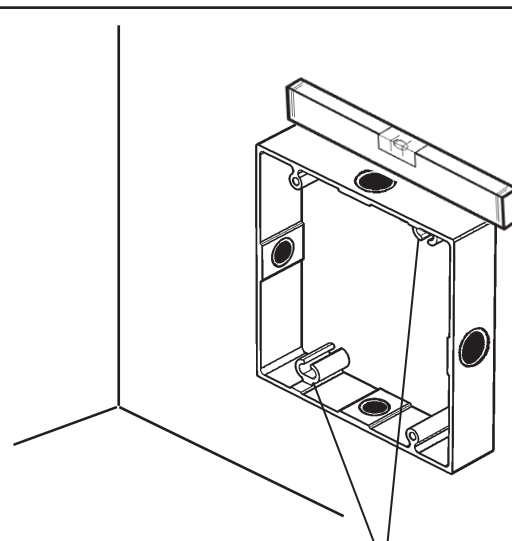
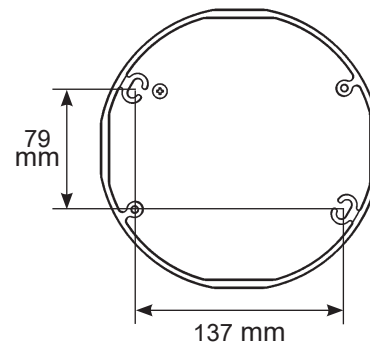
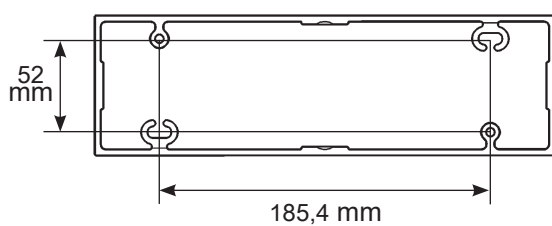
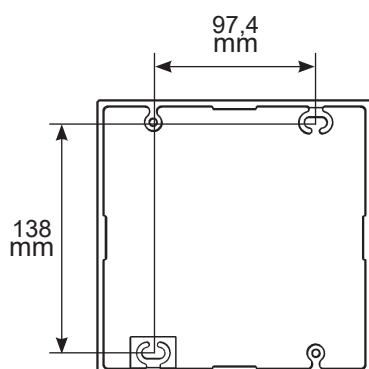

NON FORNITO
NOT SUPPLIED
NON FOURNI
NIENTE GELIEFERT
NIET BIJGELEVERD
NO SUMINISTRADO
FØLGER IKKE MED
LEVERES IKKE
MEDLEVERERAS INTE
НЕ ВХОДИТ В ПОСТАВКУ
没有供应
غير مزود

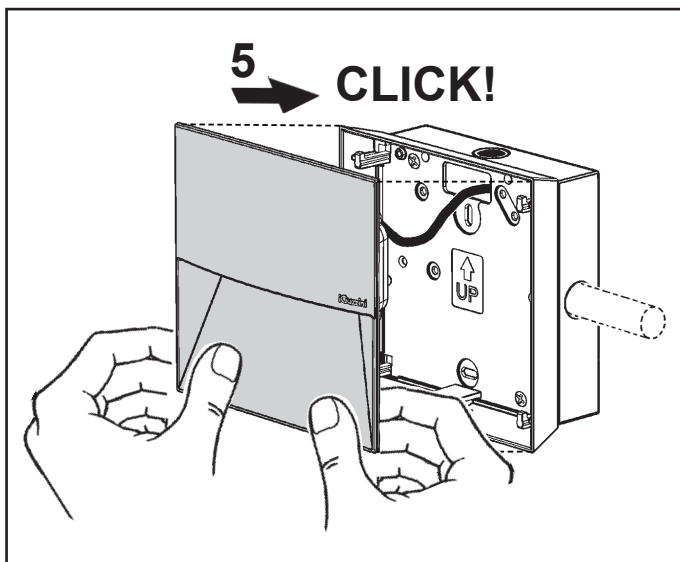
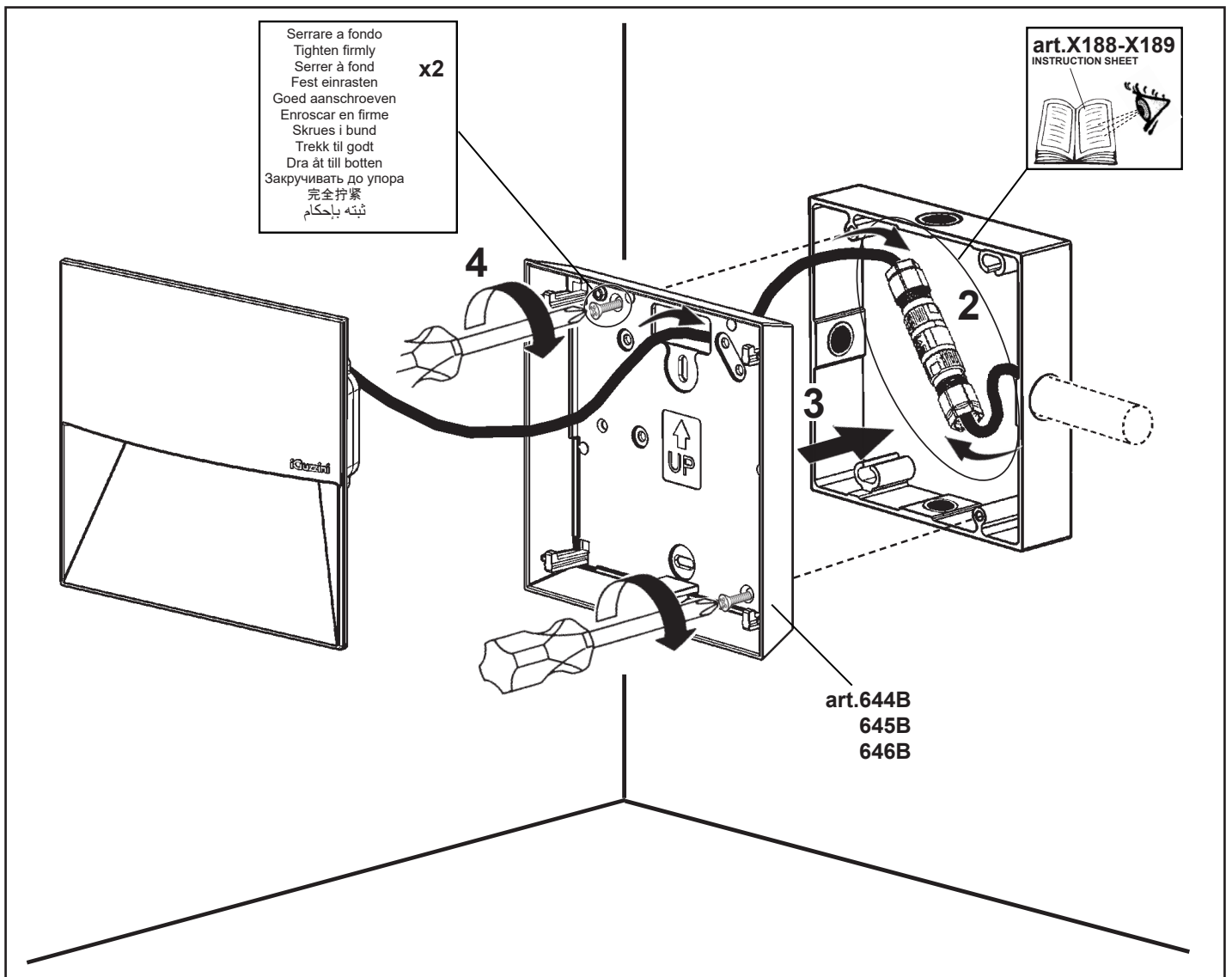

- IT Per il cablaggio elettrico fare riferimento al foglio istruzioni del prodotto.
- EN Please refer to the product instruction sheet for the electric wiring.
- FR Informations sur le câblage électrique peuvent être trouvées dans le mode d'emploi du produit.
- DE Die Membran nur an den für den Kabeldurchgang verwendeten Löchern durchstoßen.
- NL P.Voor de elektrische bedrading raadpleegt u het instructiebladje in het product.
- ES Para el cableado eléctrico hágase referencia a la hoja de instrucciones del producto.
- DA Membranen må kun gennembrydes ved de huller, der skal anvendes til kabelføring.
- NO Indhent opplysninger om ledningsføringen i produktets veiledning.
- SV Angående kabeldragningen, se produktens instruktionsblad.
- RU Порядок монтажа электропроводки смотрите в инструкциях к продукту.
- ZH 针对布线，请参阅产品说明表。
- AR بالنسبة للأسلاك الكهربائية، راجع ورقة تعليمات المنتج.