

IMPORTANT - READ CAREFULLY BEFORE INSTALLING FIXTURE. RETAIN THESE INSTRUCTIONS FOR FUTURE REFERENCE.
THIS PRODUCT MUST BE INSTALLED IN ACCORDANCE WITH THE NATIONAL ELECTRICAL CODE AND ALL APPLICABLE LOCAL CODES, BY A PERSON FAMILIAR WITH THE CONSTRUCTION AND OPERATION OF THE PRODUCT, AND THE HAZARDS INVOLVED. PROPER GROUNDING IS REQUIRED FOR SAFETY.

**NEW CONSTRUCTION PLASTER FRAME INSTALLATION (NC) - TRIM
FIXED, ADJUSTABLE OR WALL WASHER OPTIC**

- A- ENGAGE (4) HANGER BARS IN HOUSING SLOTS AVAILABLE AND CONNECT THEM TOGETHER.
B- FASTEN HANGER BARS TO CEILING BRACE WITH #8 SCREWS (**NOT INCLUDED**). HOUSING MUST BE FLUSH WITH CEILING BRACE AND INSURE SMALL FOLDED TAB IS PLACED UNDER CEILING BRACE.
C- MAKE THE CUT-OUT OPENING (**SEE DIMENSIONS BELOW**).

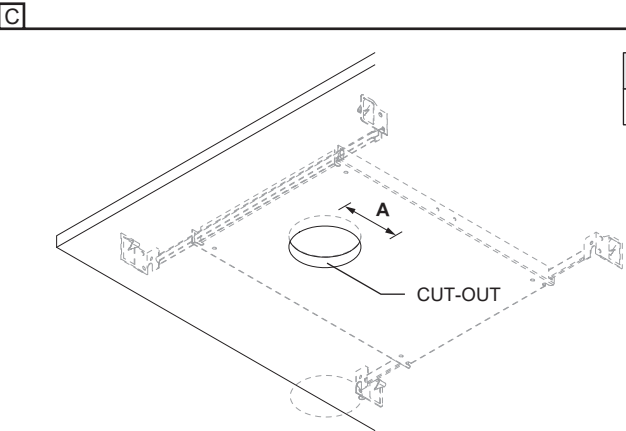
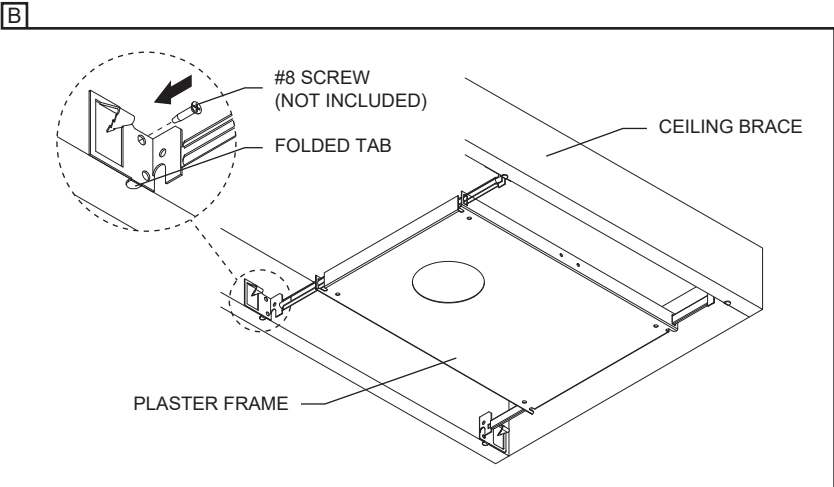
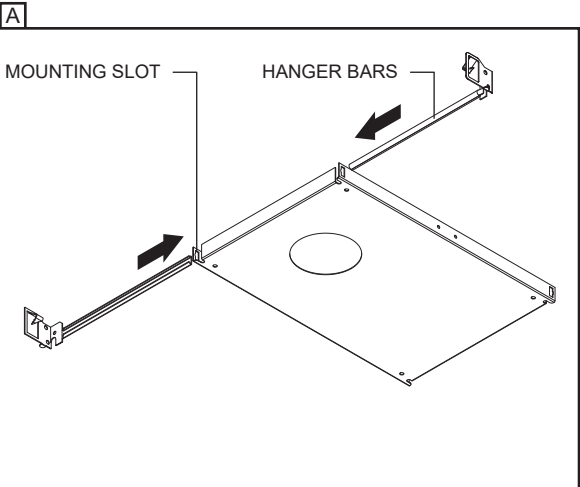

Model	Plaster Frame	Cut-out dimensions (A)	Ceiling thickness	Clearance
LASER 75	BN-LAS75RT-NC	Ø 2 ⁷ / ₈ " (Ø 73mm)	0.04"-1" (1-25mm)	6 ¹ / ₂ " (165mm)

NEW CONSTRUCTION PLASTER FRAME INSTALLATION (NC) - FIXED OR ADJUSTABLE OPTIC - TRIMLESS

- A- ENGAGE (4) HANGER BARS IN HOUSING SLOTS AVAILABLE AND CONNECT THEM TOGETHER.
B- FASTEN HANGER BARS TO CEILING BRACE WITH #6 SCREWS (**NOT INCLUDED**). HOUSING MUST BE FLUSH WITH CEILING BRACE AND INSURE SMALL FOLDED TAB IS PLACED UNDER CEILING BRACE.
C- MAKE THE CUT-OUT OPENING (**SEE DIMENSIONS BELOW**).
D- SECURE THE TRIM KIT INTO THE CEILING BY SCREWING (2) #6 SCREWS (**NOT INCLUDED**).
E- FINISH THE ASSEMBLY BY PLASTERING, SANDING AND PAINTING.

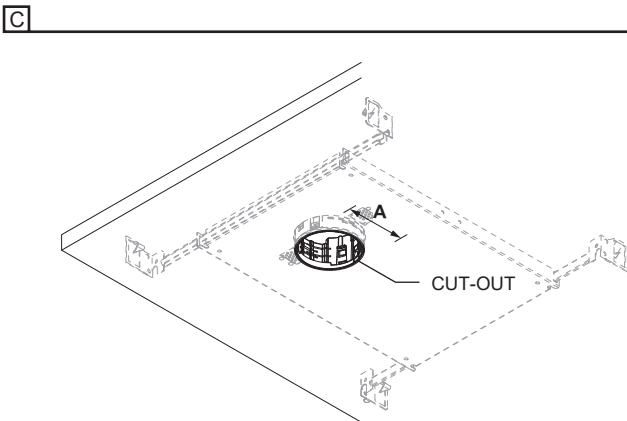
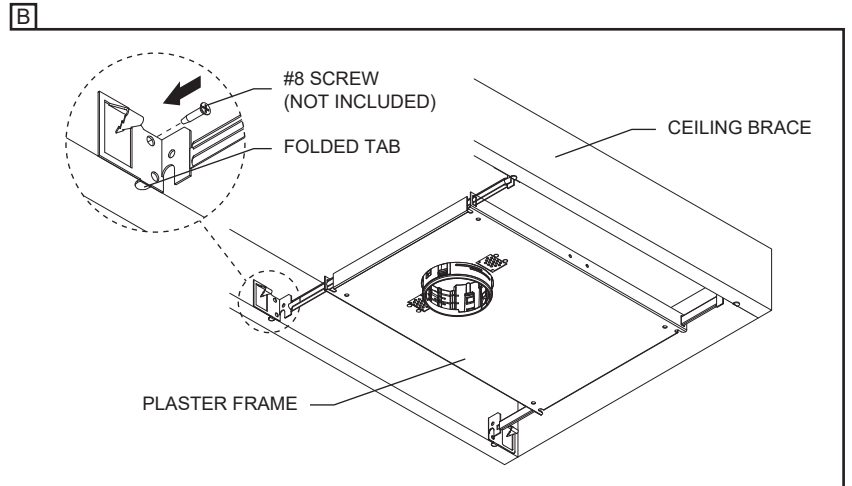
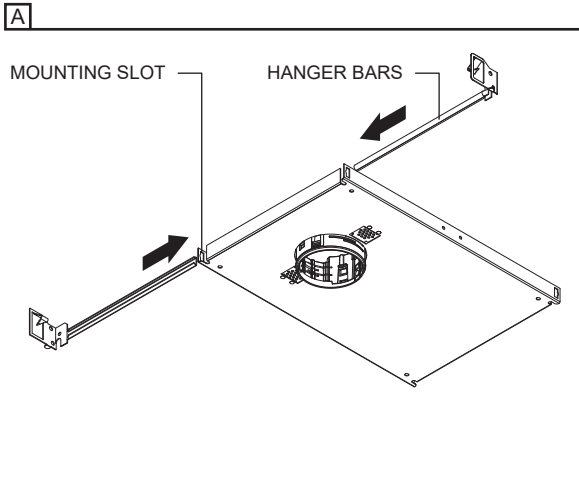

Model	Plaster Frame	Cut-out dimensions (A)	Ceiling thickness	Clearance
LASER 75	BN-LAS75RLF-NC	Ø 3" (Ø 75mm)	up to ¾" (20mm)	6½" (165mm)
	BN-LAS75RLA-NC			

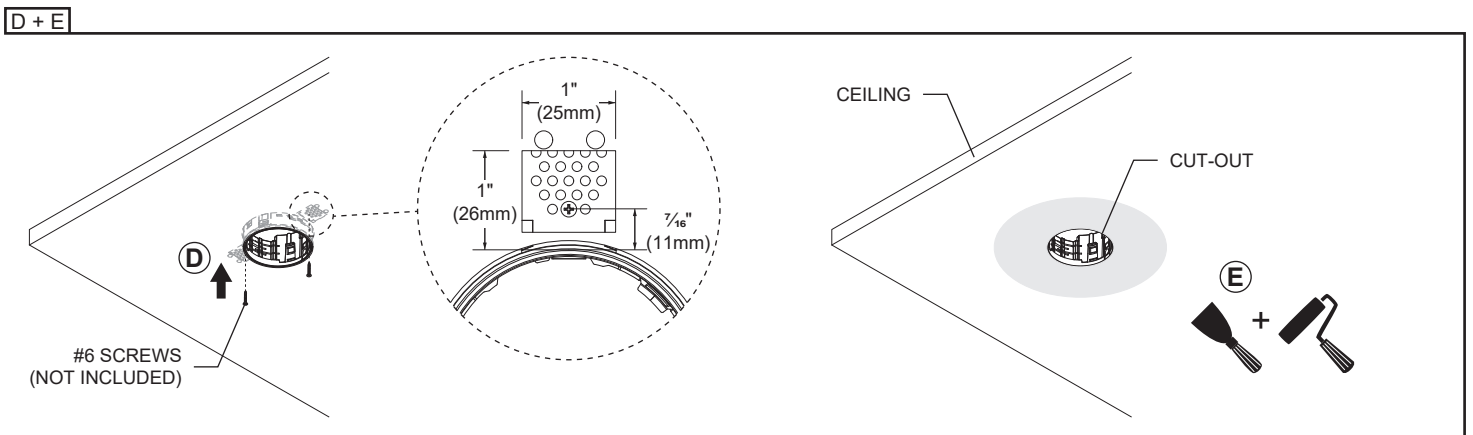

NEW CONSTRUCTION PLASTER FRAME INSTALLATION (NC) - WALL WASHER OPTIC - TRIMLESS

- A- ENGAGE (4) HANGER BARS IN HOUSING SLOTS AVAILABLE AND CONNECT THEM TOGETHER.
B- FASTEN HANGER BARS TO CEILING BRACE WITH #6 SCREWS (**NOT INCLUDED**). HOUSING MUST BE FLUSH WITH CEILING BRACE AND INSURE SMALL FOLDED TAB IS PLACED UNDER CEILING BRACE.
C- MAKE THE CUT-OUT OPENING (**SEE DIMENSIONS BELOW**).
D- POINT ONE OF THE TWO STICKERS TO THE ILLUMINATED WALL. INSERT THE TRIM AND THE TWO METAL HINGES INTO THE 12.5MM OR 20MM SLOTS. (**SEE DIAGRAM BELOW**)
E- SECURE THE TRIM KIT INTO THE CEILING BY SCREWING (2) #6 SCREWS (**NOT INCLUDED**).
F- PLACE THE FOAM CORE RING (**INCLUDED**) INTO THE TRIM AND APPLY PLASTER TO FILL THE GAP BETWEEN THE CEILING AND THE TRIM.
*REFRAIN FROM PUTTING PLASTER ONTO THE FOAM CORE RING FOR A BETTER FINISH.
G- FINISH THE ASSEMBLY BY REMOVING THE FOAM CORE RING, SANDING AND PAINTING.

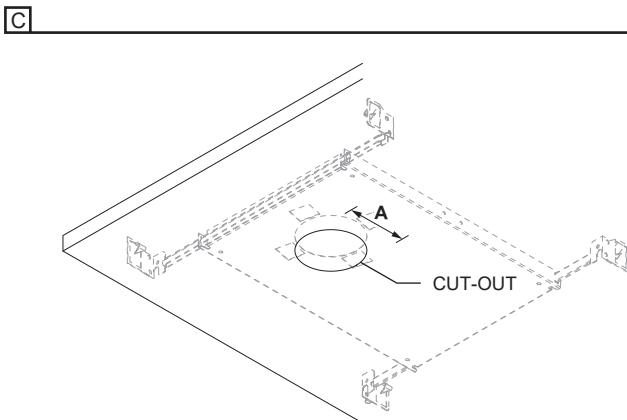
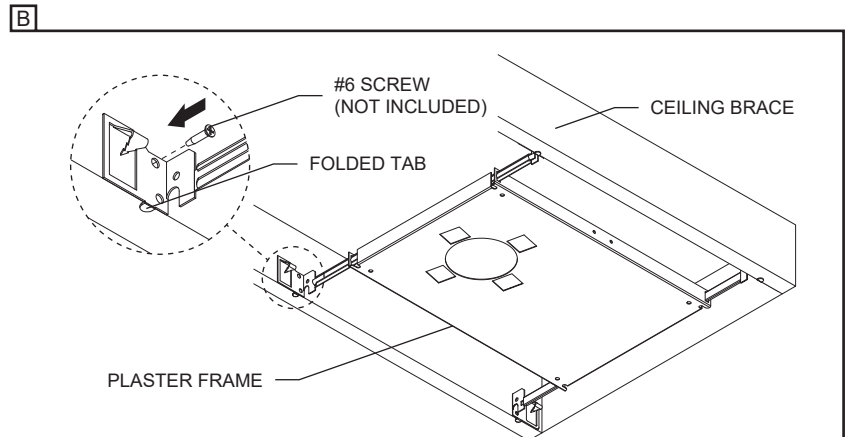
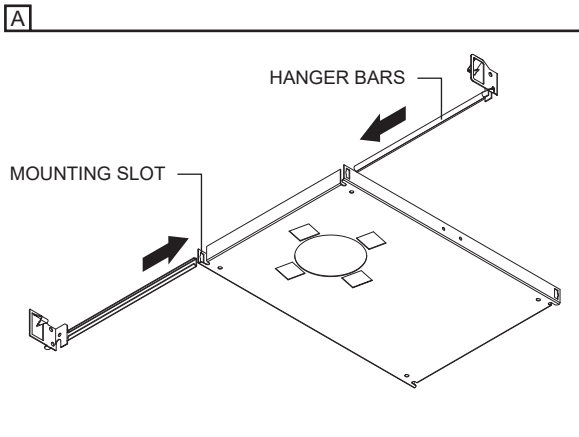

Model	Plaster Frame	Cut-out dimensions (A)	Ceiling thickness	Clearance
LASER 75	BN-LAS75RLW-NC	Ø 2 ⁵ / ₁₆ " (Ø 74mm)	0.04"-1" (1-25mm)	6 ¹ / ₂ " (165mm)

