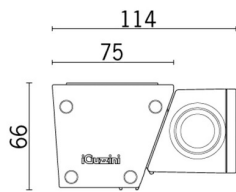

Last information update: April 2024

**Product configuration: BI71**

BI71: Compact - Wall-/Ceiling-mounted LEDs - DALI control - L=1490mm - Wall Grazing Optic

**Product code**BI71: Compact - Wall-/Ceiling-mounted LEDs - DALI control - L=1490mm - Wall Grazing Optic **Attention! Code no longer in production****Technical description**

Direct light luminaire, designed to use RGB LED lamps (Red, Green, Blue) and Dali control. Ceiling- and wall-mounted. Consists of a body and supports for installation, to be ordered separately. Extruded aluminium body, with die-cast aluminium end caps complete with silicone seals. Coated with liquid acrylic paint with a high level of weather and UV ray resistance. Lateral control gear box made of PPS (polyphenylene sulfide). The top of the optical assembly is closed by a 3 mm thick transparent glass screen, fixed with silicone. Complete with multi-LED plate with individual LEDs in Red, Green and Blue (RGB). Fitted with optics with plastic (methacrylate) lens for Wall Grazing lighting. The lateral box is supplied with a double connector, male/female, with 5-pin quick coupling for pass-through wiring and a closing cap on one side. Set up for pass-through earth wiring. All external screws used are made of A2 stainless steel. The luminaire technical characteristics conform to EN 60598-1 standards and particular requirements.

**Installation**

Accessories available for installation:  $\pm 90^\circ$  adjustable arms L=138mm (code 5576), arms extendable from 309 to 389mm and adjustable  $\pm 90^\circ$  (code 5577), bracket for wall-mounting L=670mm (code BZI1), brackets for mounting on balustrades L297mm (code 5578), bracket for surface- or ceiling-mounting L=644mm (code 5571).

**Colour**

Grey (15)

**Weight (Kg)**

4.29

**Mounting**

wall surface/ceiling surface

**Wiring**

The product is supplied with electronic control gear, Dali dimmable 220÷240Vac, 50/60Hz contained in the luminaire. Available for electrical connection and Dali control: IP66 5-pin female connector (BZI5), IP66 5-pin male connector + closing cap (BZI6), IP66 5-pin male connector + female connector (BZI7), multi-pole cable units with 5-pin male + female connectors (BZT4-BZT5-BZT6)

**Notes**

Product complete with LED lamp. The electronic board takes three Dali addresses, absorbs one Dali load.

Complies with EN60598-1 and pertinent regulations

**Technical data**

lm system:	1475	Life Time LED 1:	50,000h - L80 - B10 (Ta 25°C)
W system:	45.1	Life Time LED 2:	50,000h - L80 - B20 (Ta 40°C)
lm source:	2300	Lamp code:	LED
W source:	40	Number of lamps for optical assembly:	1
Luminous efficiency (lm/W, real value):	32.7	ZVEI Code:	LED
lm in emergency mode:	-	Number of optical assemblies:	1
Total light flux at or above an angle of 90° [Lm]:	0	Intervallo temperatura ambiente:	from -30°C to 50°C.
Light Output Ratio (L.O.R.) [%]:	64	Control:	DALI
Colour temperature [K]:	RGB		

Polar

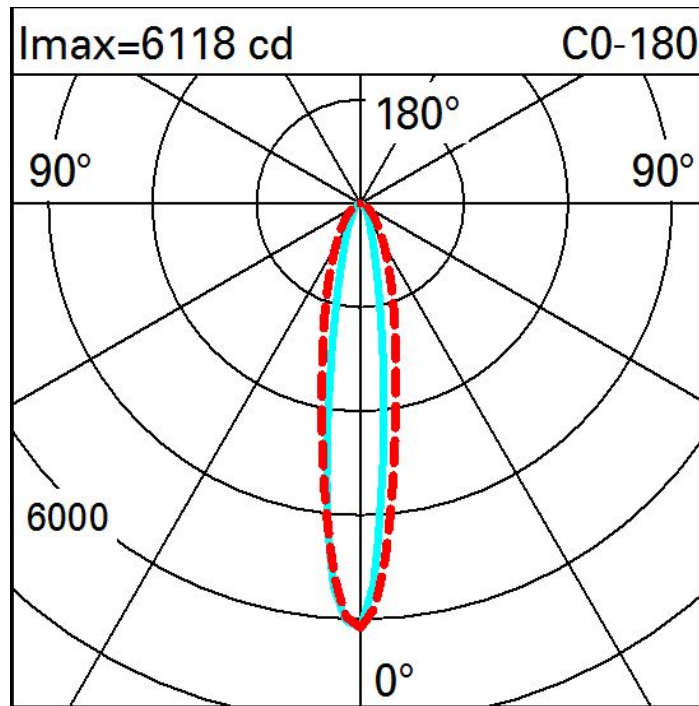

Illuminances

Lux												Wall distance = 1m	
3													
	0.5	1	3	8	20	31	21	9	3	1	0.5		
2	2	3	7	15	29	40	31	17	8	3	2		
	3	5	9	17	30	39	32	19	9	5	3		
1	3	5	9	17	28	36	29	18	10	5	3		
	3	5	9	15	24	31	25	17	10	6	3		
0													
	m	-2	-1		0		1		2	3			