

PALCO IN-OUT

WARNING:

THE SAFETY OF THIS FIXTURE IS GUARANTEED ONLY IF YOU COMPLY WITH THESE INSTRUCTIONS; REMEMBER TO CONSERVE IN A SAFE PLACE.

ATTENTION:

LA SÉCURITÉ DE L'APPAREIL N'EST GARANTIE QU'EN CAS D'UTILISATION CORRECTE DES INSTRUCTIONS SUIVANTES; IL FAUT PAR CONSÉQUENT LES CONSERVER.

ATTENCIÓN:

LA SEGURIDAD DEL APARATO SE GARANTIZA SOLO CUMPLIENDO CUIDADOSAMENTE LAS SIGUIENTES INSTRUCCIONES; ES NECESARIO CONSERVARLAS.

ATTENZIONE:

LA SICUREZZA DELL'APPARECCHIO E' GARANTITA SOLO CON L'USO APPROPRIATO DELLE SEGUENTI ISTRUZIONI; PERTANTO E' NECESSARIO CONSERVARE.

EN INSTALL IN ACCORDANCE WITH NATIONAL ELECTRIC CODE, LOCAL AND FEDERAL CODE SPECIFICATION.

FR VEUILLEZ INSTALLER CE PRODUIT EN CONFORMITÉ AVEC LE CODE ÉLECTRIQUE NATIONAL ET LES SPÉCIFICATIONS DU CODE LOCAL ET FÉDÉRAL.

ES INSTALAR EL PRODUCTO RESPETANDO LAS NORMAS ELÉCTRICAS NACIONALES Y LAS ESPECIFICACIONES DE LAS NORMAS LOCALES Y FEDERALES.

IT SI PREGA DI INSTALLARE QUESTO CONFORMITÀ CON IL NATIONAL ELECTRICAL CODE E LE SPECIFICHE DEL CODICE LOCALE E FEDERALE.

EN N.B.: WHEN INSTALLING THE SYSTEM, STRICTLY COMPLY WITH ALL REGULATIONS ON INSTALLATION IN FORCE.

FR N.B.: LORS DE L'INSTALLATION DU SYSTÈME VEILLER RESPECTER RIGOREUSEMENT LES NORMES EN VIGUEUR EN LA MATIÈRE.

ES N.B.: DURANTE LA INSTALACIÓN DEL SISTEMA RESPECTAR E SCRUPULOSAMENTE LAS NORMAS DE INSTALACIÓN VIGENTES.

IT N.B.: DURANTE L'INSTALLAZIONE DEL SISTEMA RISPETTARE SCRUPOLOSAMENTE LE NORME IMPIANTISTICHE VIGENTI.

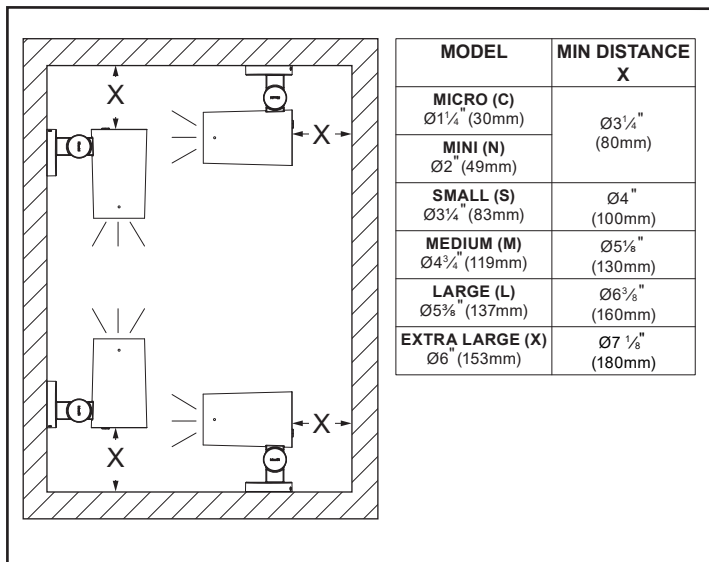
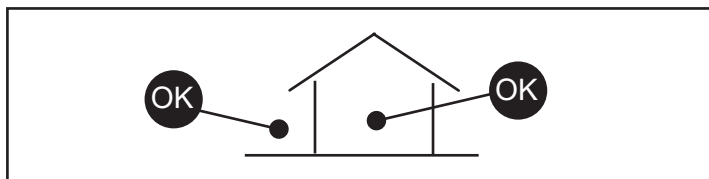
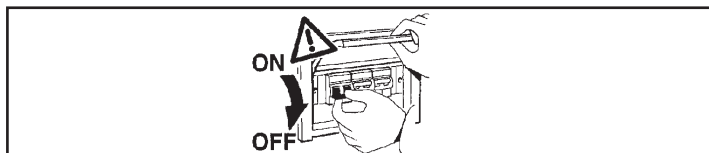

EN Maximum size, weight and area of the luminaire complete with accessories.

FR Dimensions, poids et surface maximum d'encombrement du luminaire avec les accessoires.

ES Tamaño, peso y superficie máximos de la luminaria completa con accesorios.

IT Dimensioni, peso e superficie massime dell'apparecchio completo di accessori.

MODELS	WEIGHT POIDS PESO PESO lb (kg)	DIMENSION / DIMENSION DIMENSION / DIMIIONI a x b inch (mm)
REMOTE MODELS		
MICRO (C) Ø1¼" (30mm)	0.44lb (0.2kg)	3¾" x 3" (96 x 75mm)
MINI (N) Ø2" (49mm)	1.1lb (0.5kg)	5¼" x 3⅞" (132 x 96mm)
SMALL (S) Ø3¼" (83mm)	3.31lb (1.5kg)	9" x 6½" (227 x 163mm)
INTEGRAL MODELS		
SMALL (S) Ø3¼" (83mm)	3.7lb (1.68kg)	9" x 7 ⅝" (227 x 192mm)
MEDIUM (M) Ø4¾" (119mm)	9.26lb (4.2kg)	12⅞" x 9⅞" (326 x 250mm)
LARGE (L) Ø5½" (137mm)	13.23lb (5.5kg)	15" x 11¼" (380 x 284mm)
EXTRA LARGE (X) Ø6" (153mm)	14.46lb (6.5kg)	16" x 11⅞" (404 x 302mm)

MODELS	OUTPUT	OUTSIDE TEMPERATURE MIN	OUTSIDE TEMPERATURE MAX
MICRO (C) Ø1¼" (30mm)	Base output (BO)	⊖ -30°C (-22°F)	⊕ 50°C (122°F)
MINI (N) Ø2" (49mm)	Base output (BO)	⊖ -30°C (-22°F)	⊕ 50°C (122°F)
SMALL (S) Ø3¼" (83mm)	Base output (BO)	⊖ -30°C (-22°F)	⊕ 50°C (122°F)
	High output (HO)	⊖ -30°C (-22°F)	⊕ 35°C (95°F)
MEDIUM (M) Ø4¾" (119mm)	High efficiency (HE)	⊖ -30°C (-22°F)	⊕ 50°C (122°F)
	Base output (BO)	⊖ -30°C (-22°F)	⊕ 50°C (122°F)
	High output (HO)	⊖ -30°C (-22°F)	⊕ 35°C (95°F)
LARGE (L) Ø5½" (137mm)	Very high output (VHO)	⊖ -30°C (-22°F)	⊕ 35°C (95°F)
	High efficiency (HE)	⊖ -30°C (-22°F)	⊕ 50°C (122°F)
	Base output (BO)	⊖ -30°C (-22°F)	⊕ 50°C (122°F)
	High output (HO)	⊖ -30°C (-22°F)	⊕ 35°C (95°F)
EXTRA LARGE (X) Ø6" (153mm)	Very high output (VHO)	⊖ -30°C (-22°F)	⊕ 50°C (122°F)
	Base output (BO)	⊖ -30°C (-22°F)	⊕ 50°C (122°F)

C **N** **S** **REMOTE MODELS**
 MICRO MINI SMALL

EN Avoid letting the product come into direct contact with the ground.
FR Éviter le contact direct du produit avec le sol.
ES Evitar el contacto directo del producto con el terreno.
IT Evitare il contatto diretto del prodotto con il terreno.

EN Do not install the fixture in areas where water tends to collect.
FR Ne pas installer le produit dans un endroit à risque de stagnation d'eau.
ES No usar el producto para instalaciones en lugares donde hay agua estancada.
IT No installare il prodotto in luoghi soggenti al ristagno dell'acqua.

EN The cable should be suitably protected against direct contact with the ground.
FR Nous conseillons de protéger adéquatement le câble du contact direct avec le sol.
ES Se recomienda proteger adecuadamente el cable del contacto directo con el terreno.
IT Si consiglia di proteggere adeguatamente il cavo dal contatto diretto con il terreno.

CONNECTION ON OCTAGONAL 4" JUNCTION BOX

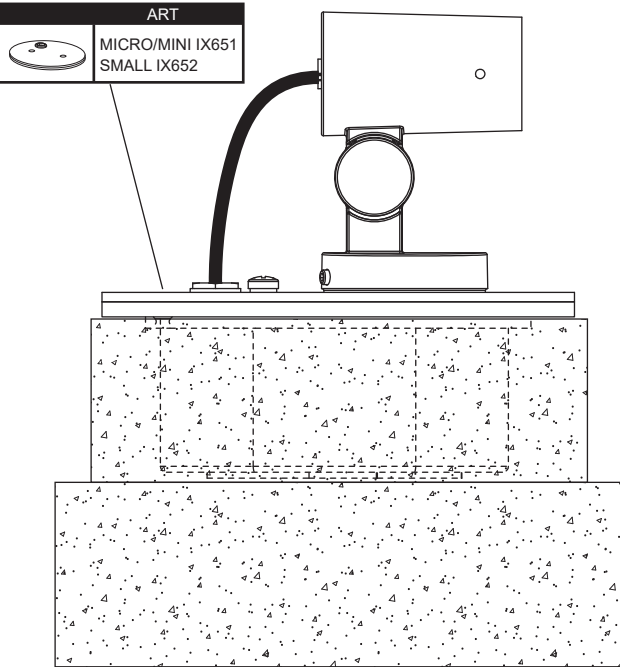

TO REMOTE BOX (BY OTHERS)

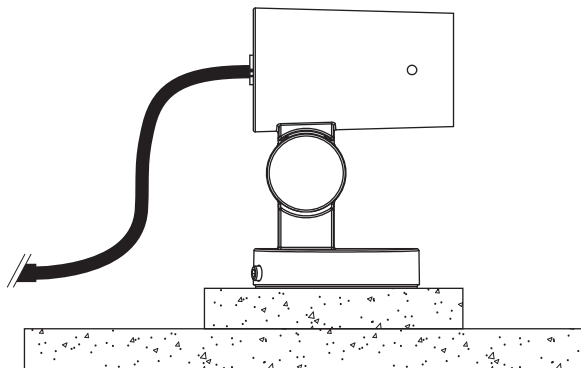

EN Make sure area onto which the frame will rest is free of any projections.
FR Eviter que la zone sur laquelle reposera le cadre présente des aspérités.
ES Asegurarse de que el área, sobre la que se apoyará el marco, no presente salientes.
IT Accertarsi che l'area sulla quale poggierà la cornice non presenti sporgenze.

C **N**
 MICRO MINI

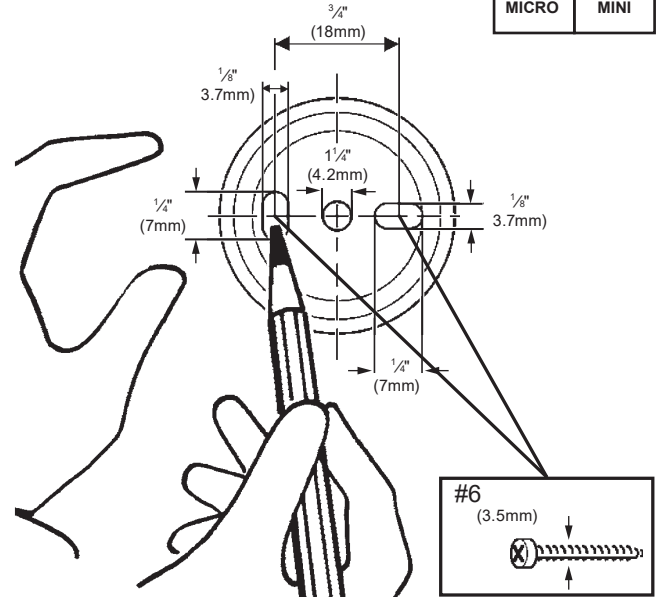

S
 SMALL

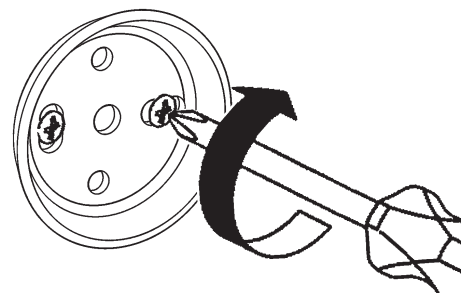
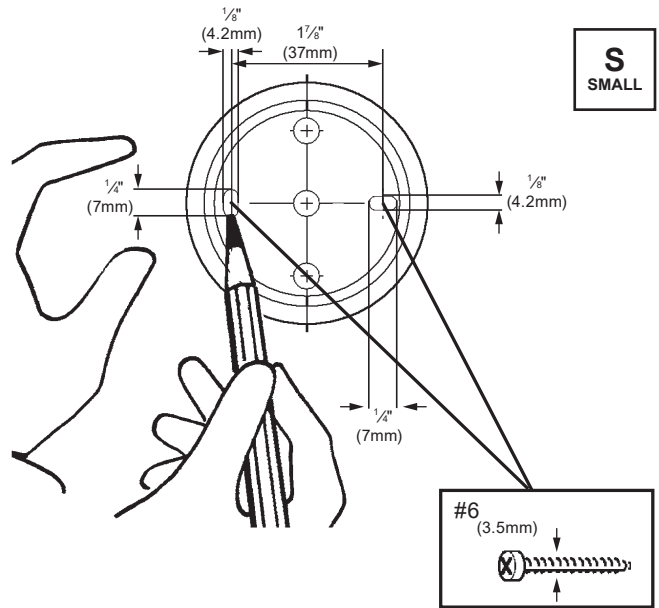

LED +	RED
LED -	BLACK

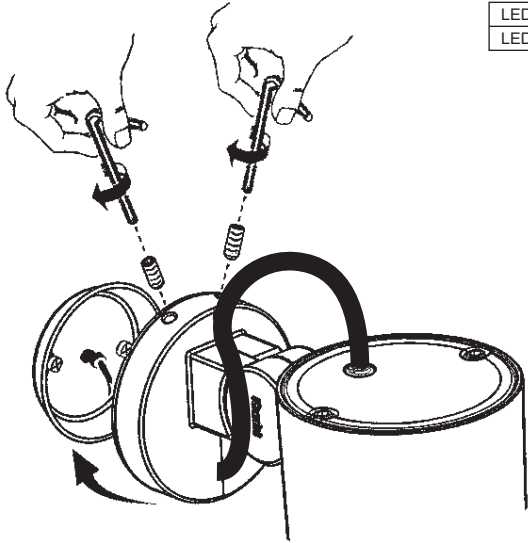

C MICRO	N MINI
-------------------	------------------

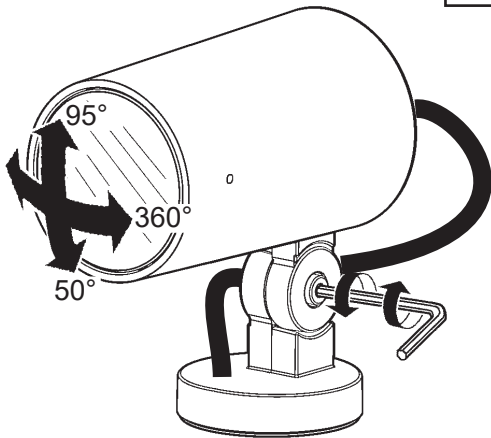

S SMALL

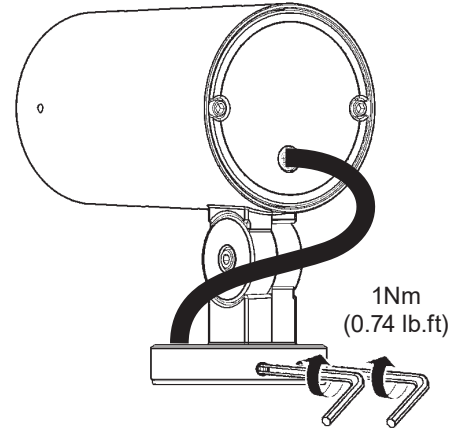
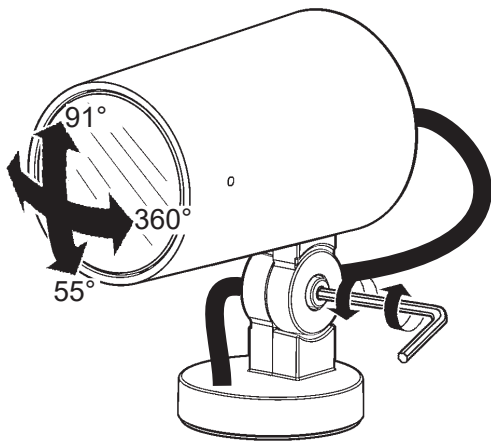

S SMALL	M MEDIUM	L LARGE	X EXTRA LARGE	INTEGRAL MODELS
-------------------	--------------------	-------------------	-------------------------	------------------------

- EN** Avoid letting the product come into direct contact with the ground.
 - FR** Éviter le contact direct du produit avec le sol.
 - ES** Evitar el contacto directo del producto con el terreno
 - IT** Evitare il contatto diretto del prodotto con il terreno.
-
- EN** Do not install the fixture in areas where water tends to collect.
 - FR** Ne pas installer le produit dans un endroit à risque de stagnation d'eau.
 - ES** No usar el producto para instalaciones en lugares donde hay agua estancada.
 - IT** No installare il prodotto in luoghi soggenti al ristagno dell'acqua.

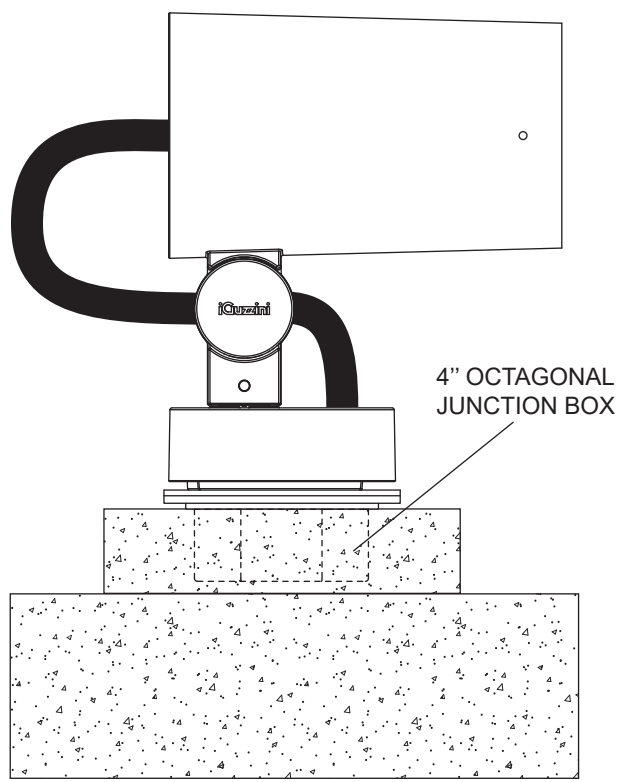

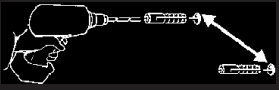

S SMALL	M MEDIUM	L LARGE	X EXTRA LARGE
-------------------	--------------------	-------------------	-------------------------

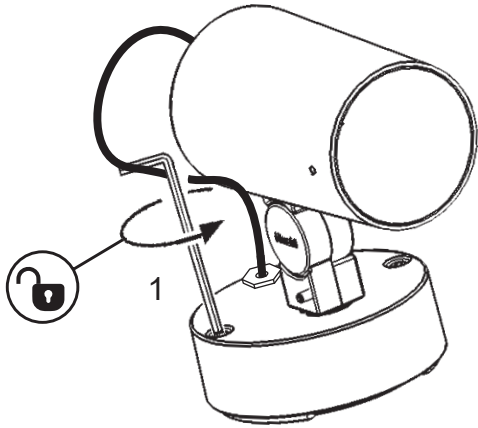

4" OCTAGONAL JUNCTION BOX

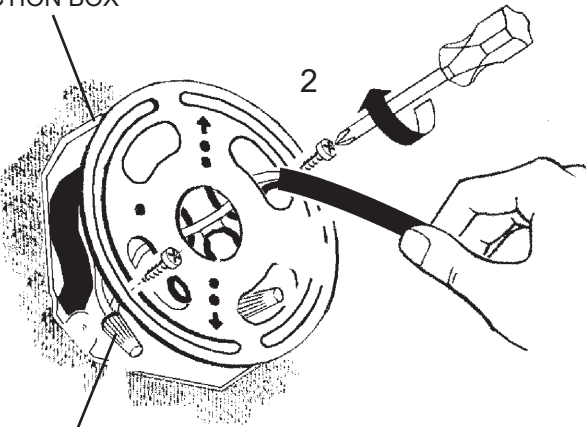

By others
Non fornito
No suministrado
Non fornito



WIRING DIAGRAM
DIMMING (D10)
0-10V (120V, 120-277V)

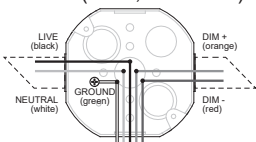

FIXTURE CABLES

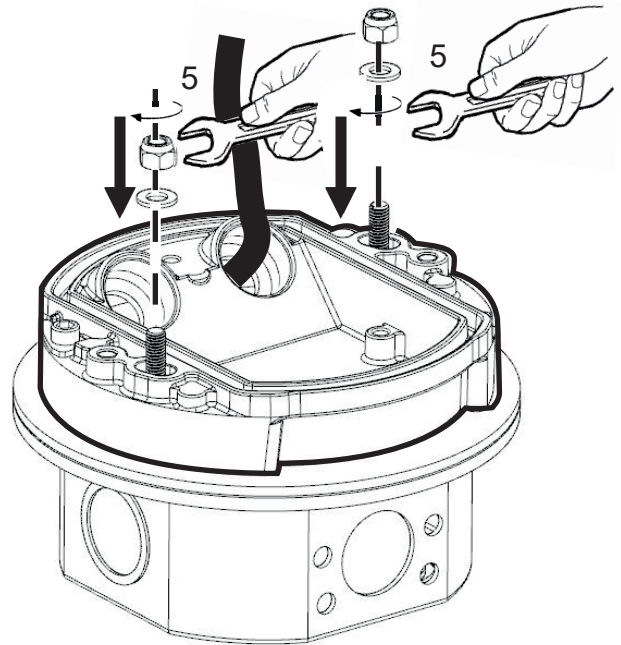
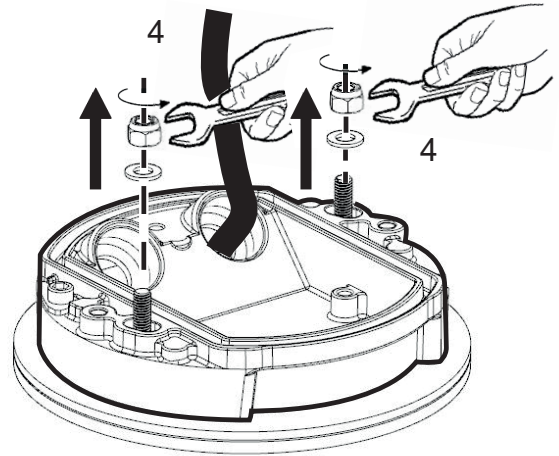
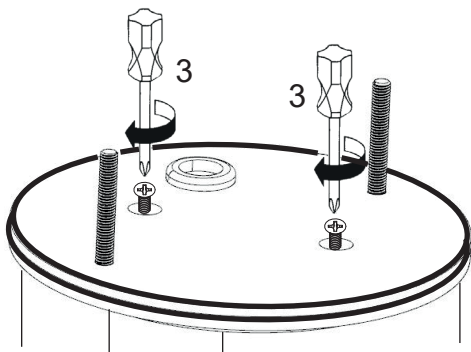

3Nm
(2.21 lb.ft)

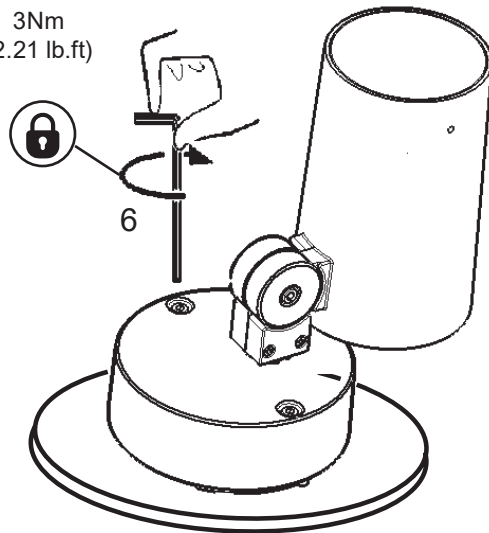



S
SMALL

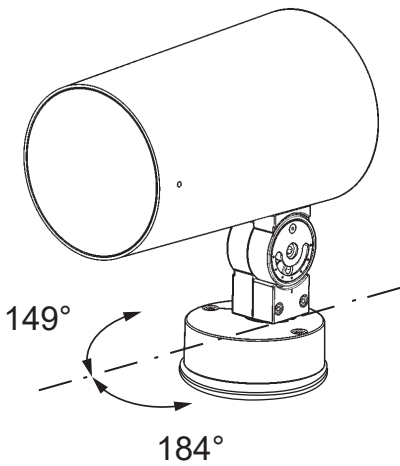
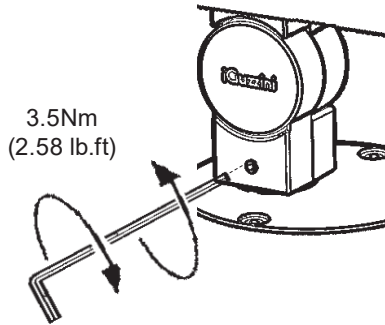
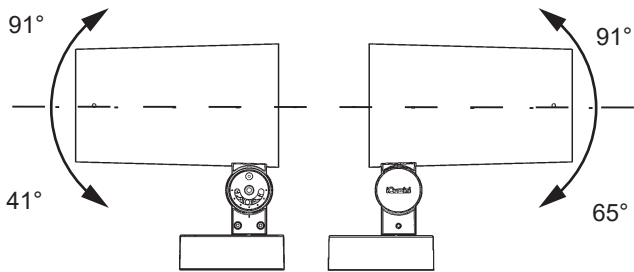
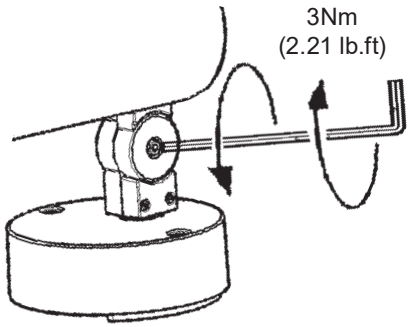

M
MEDIUM

6Nm
(4.43 lb.ft)

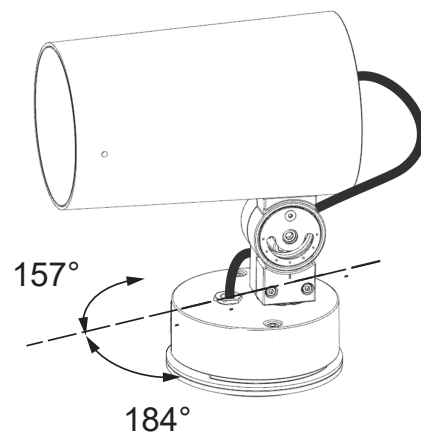
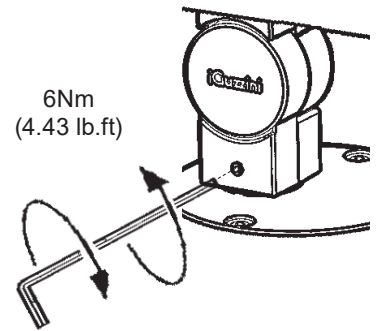
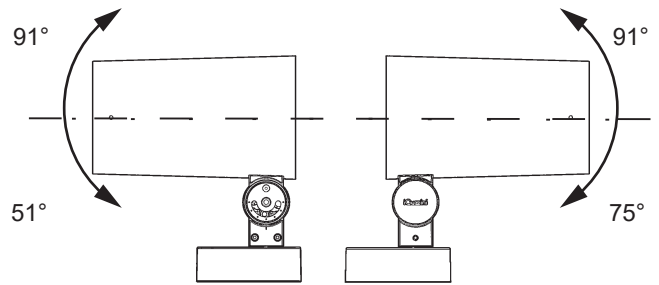
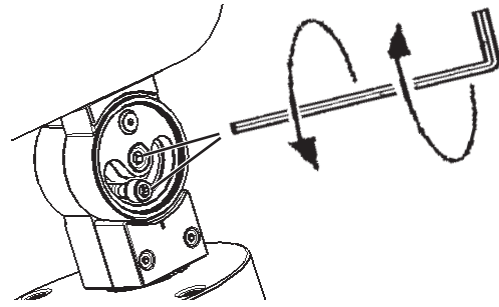





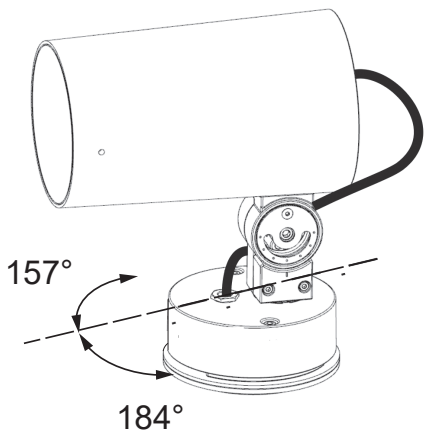
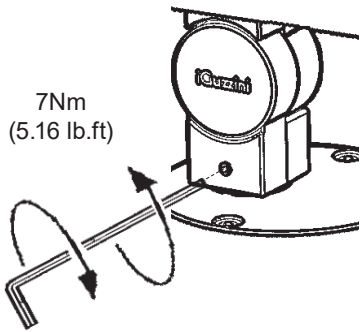
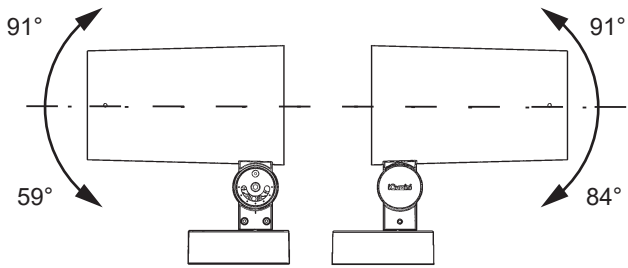
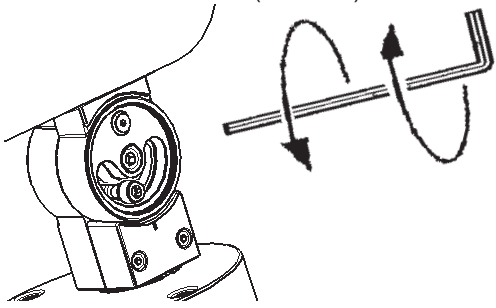



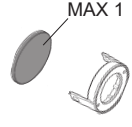

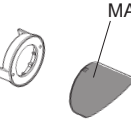

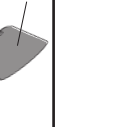





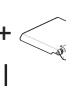
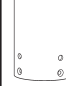
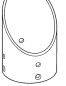

L LARGE	X EXTRA LARGE
-------------------	-------------------------

13Nm
(9.59 lb.ft)



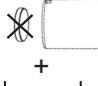
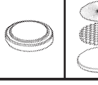
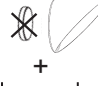
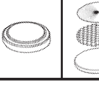
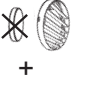
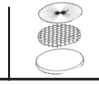

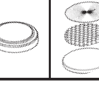
ACCESSORIES

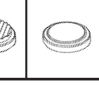
	  MAX 1				  MAX 1					  MAX 1		
												
MICRO (C) Ø1¼" (30mm)	IX243	IX259	IX263	IX255	IX247	IX251	X	X	X	X	IX539	IX533
MINI (N) Ø2" (49mm)	IX244	IX260	IX264	IX256	IX248	IX252	X	X	X	X	IX540	IX534
SMALL (S) Ø3¼" (83mm)	IX245	IX261	IX265	IX257	IX249	IX253	IX267	X	X	X	IX541	IX535
MEDIUM (M) Ø4¾" (119mm)	IX246	IX262	IX266	IX258	IX250	IX254	IX268	IX275	IX320	IX269	IX542	IX536
LARGE (L) Ø5½" (137mm)	IX302	IX310	IX312	IX308	IX304	IX306	IX314	IX318	IX321	IX316	IX543	IX537
EXTRA LARGE (X) Ø6" (153mm)	IX303	IX311	IX313	IX309	IX305	IX307	IX315	IX319	IX322	IX317	IX544	IX538

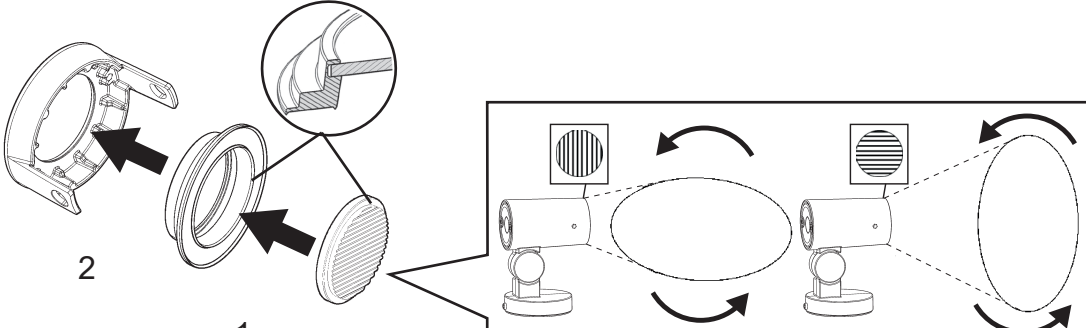
					
	 + 	 + 	 + 	 + 	 + 
MICRO (C) Ø1¼" (30mm)	✓	✓	✗	✗	✗
MINI (N) Ø2" (49mm)	✓	✓	✗	✗	✗
SMALL (S) Ø3¼" (83mm)	✓	✓	✓	✗	✗
MEDIUM (M) Ø4¾" (119mm)	✓	✓	✓	✓	✓
LARGE (L) Ø5½" (137mm)	✓	✓	✓	✓	✓
EXTRA LARGE (X) Ø6" (153mm)	✓	✓	✓	✓	✓



ART.	
	IX243 - IX244 - IX245 IX246 - IX302 - IX303
	IX259 - IX260 - IX261 IX262 - IX310 - IX311
	IX263 - IX264 - IX265 IX266 - IX312 - IX313

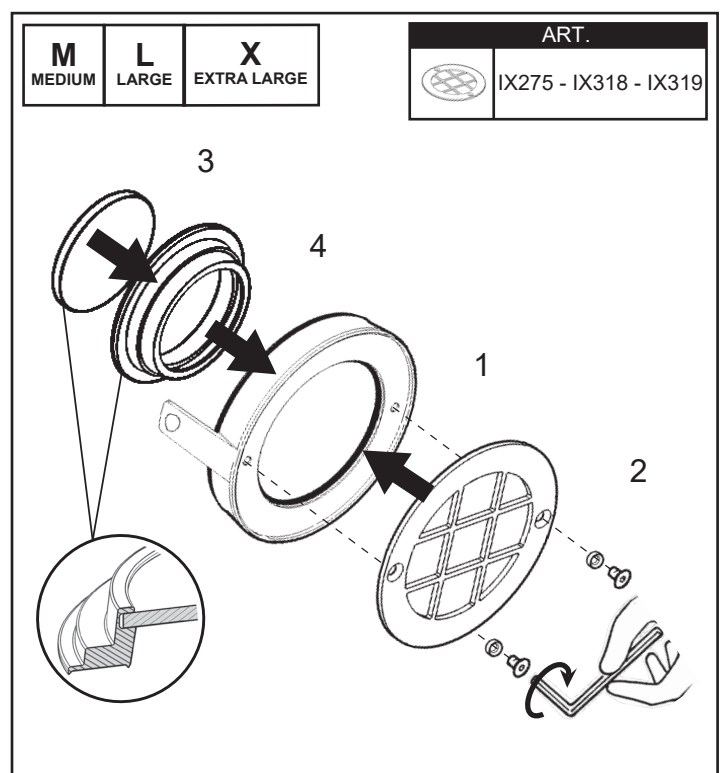
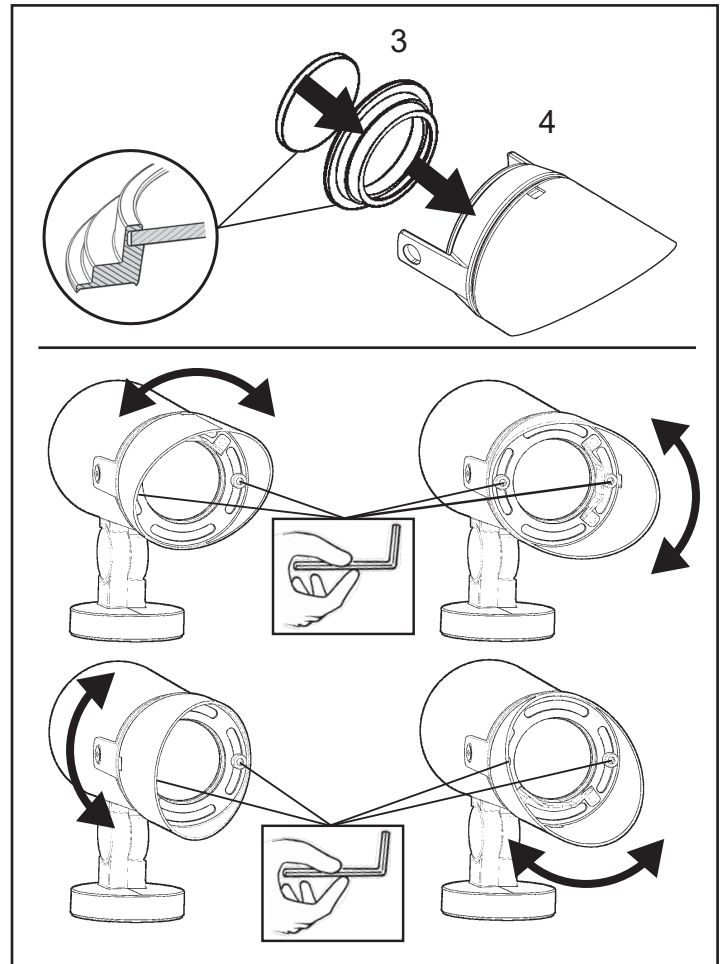
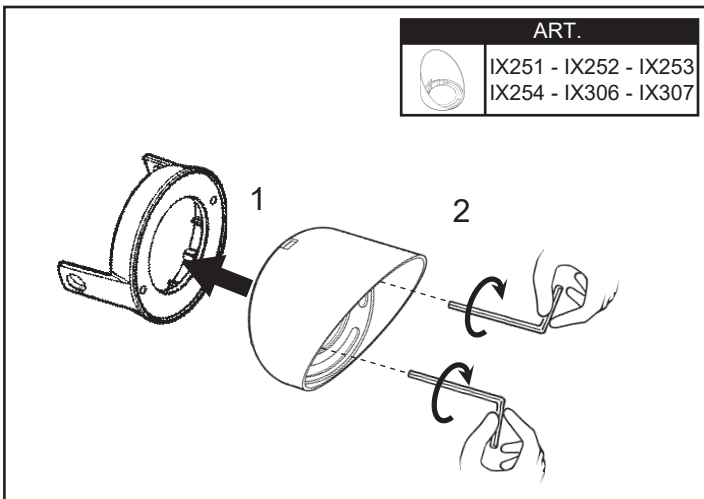
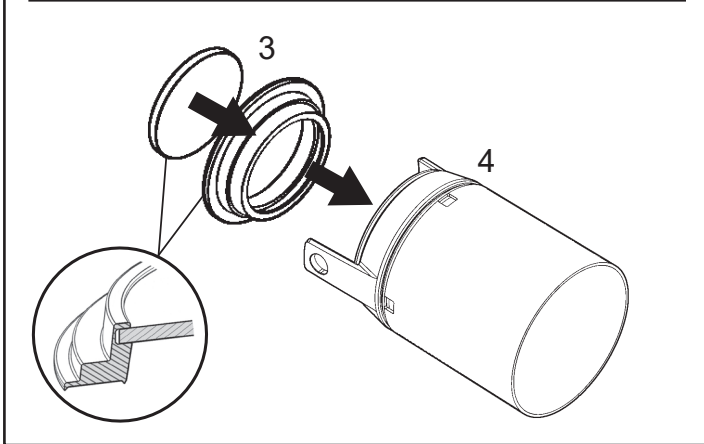
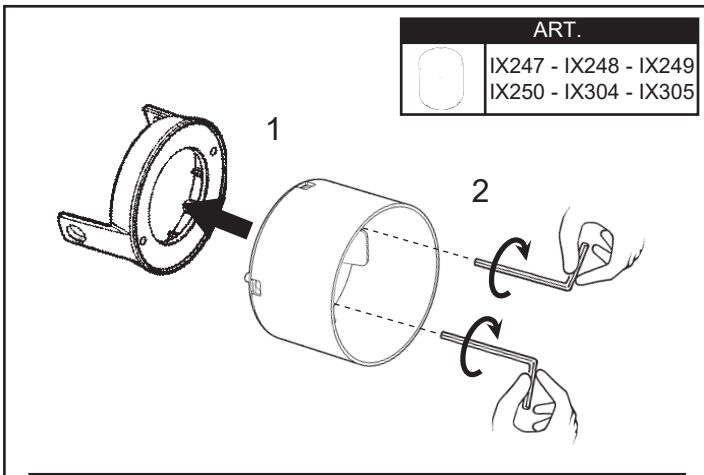
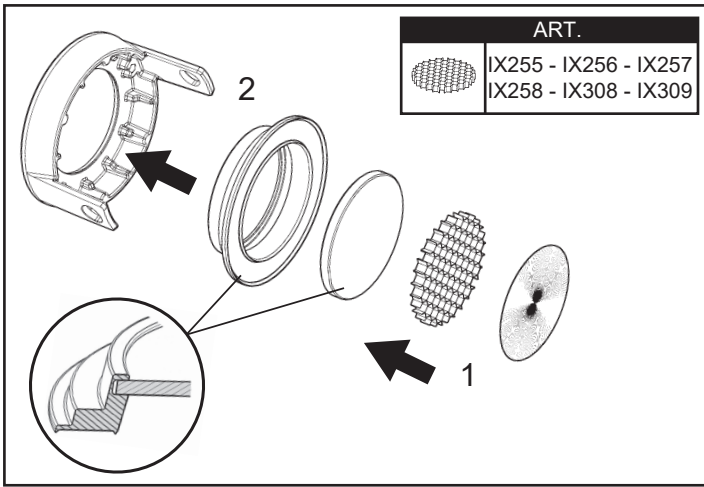

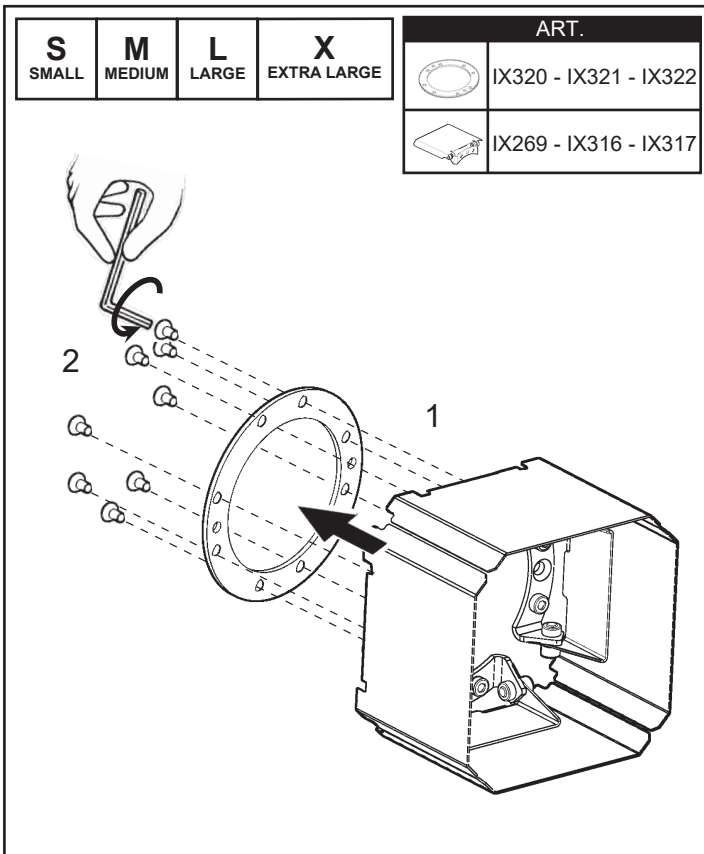
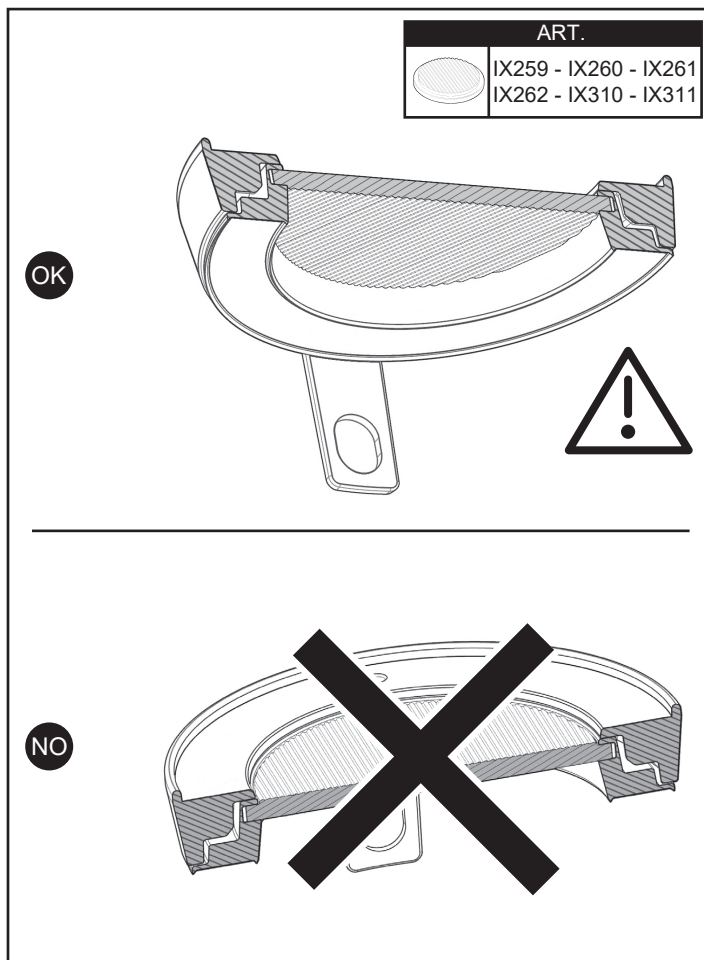
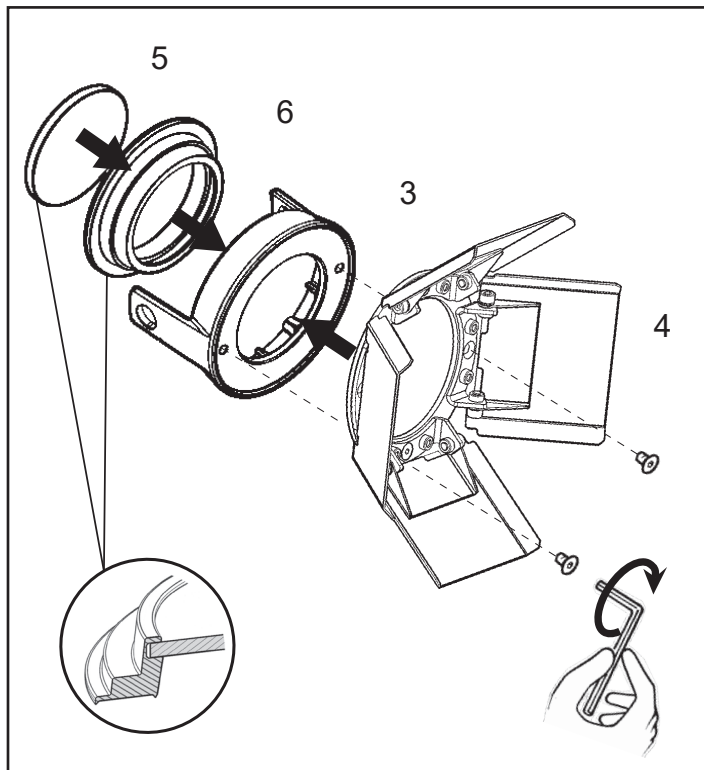
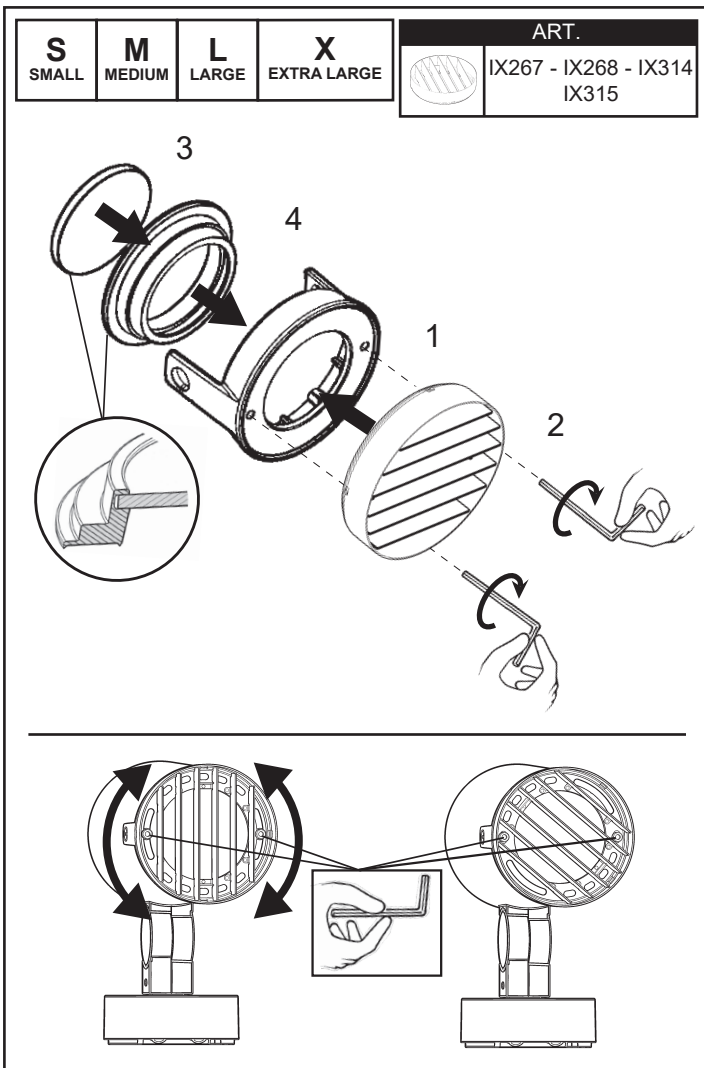

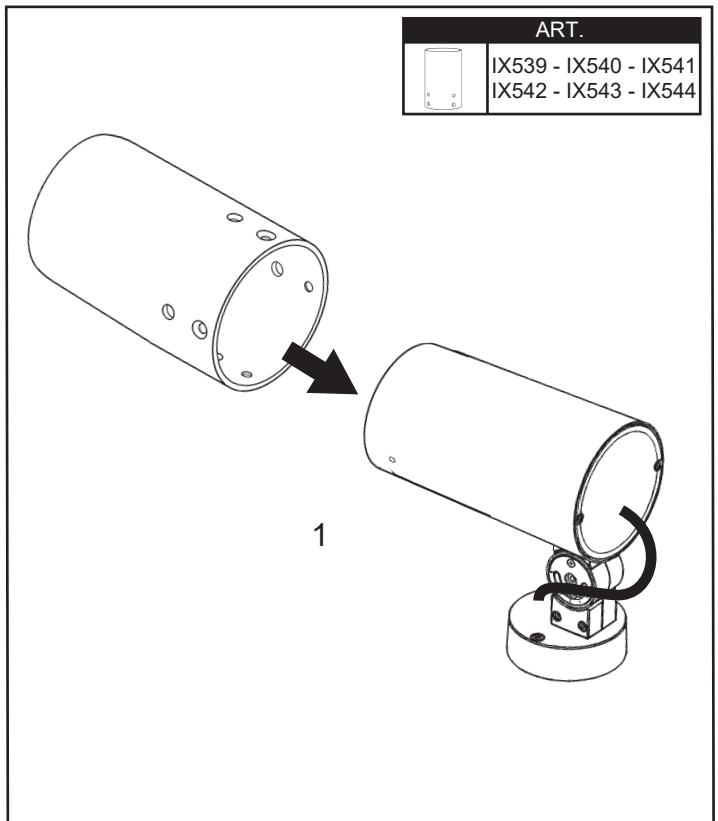
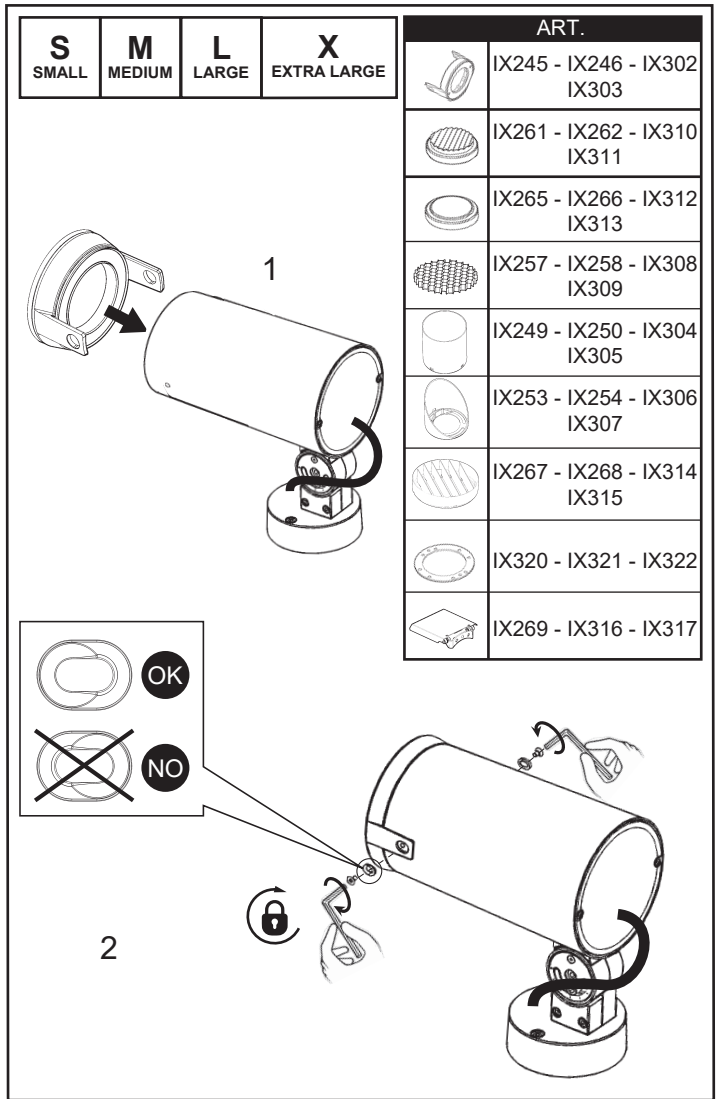
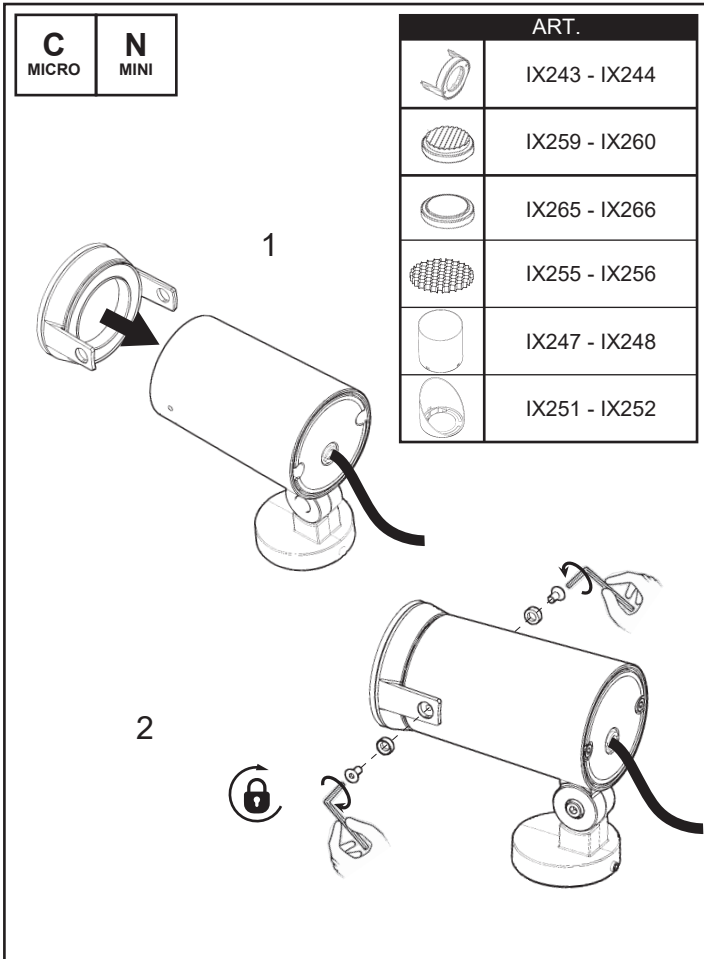
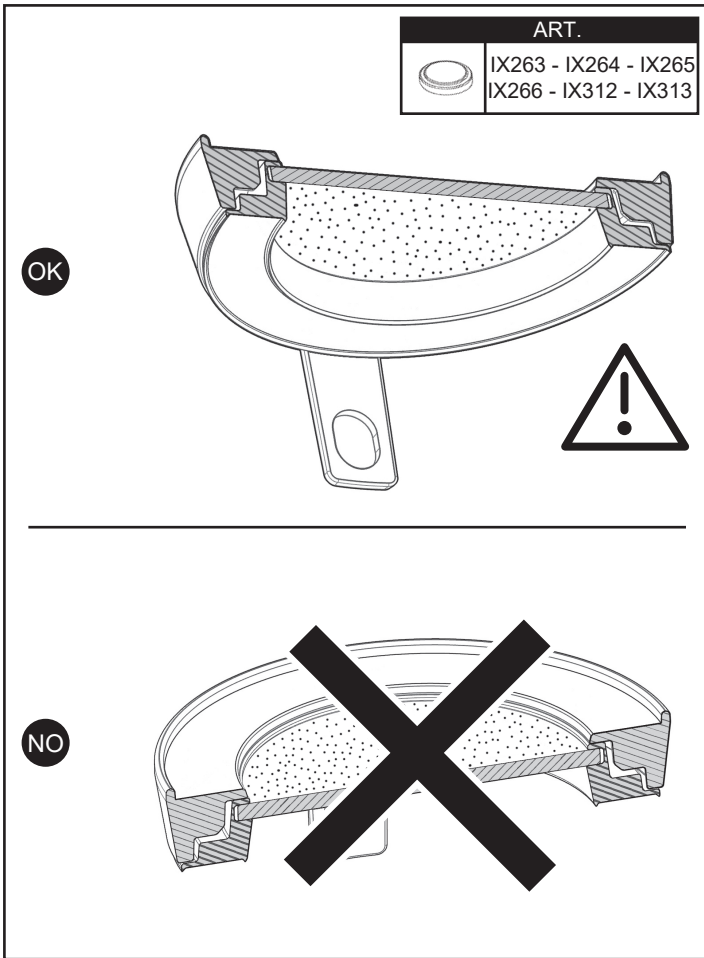

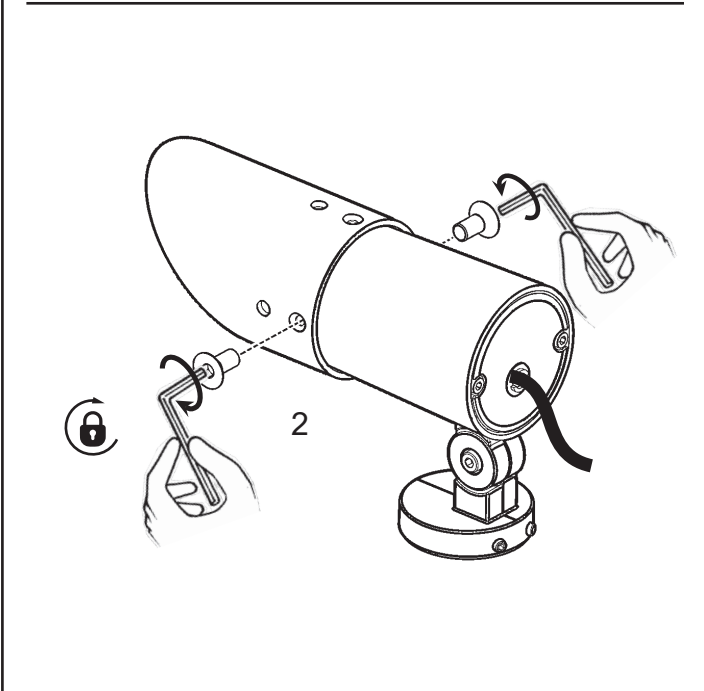
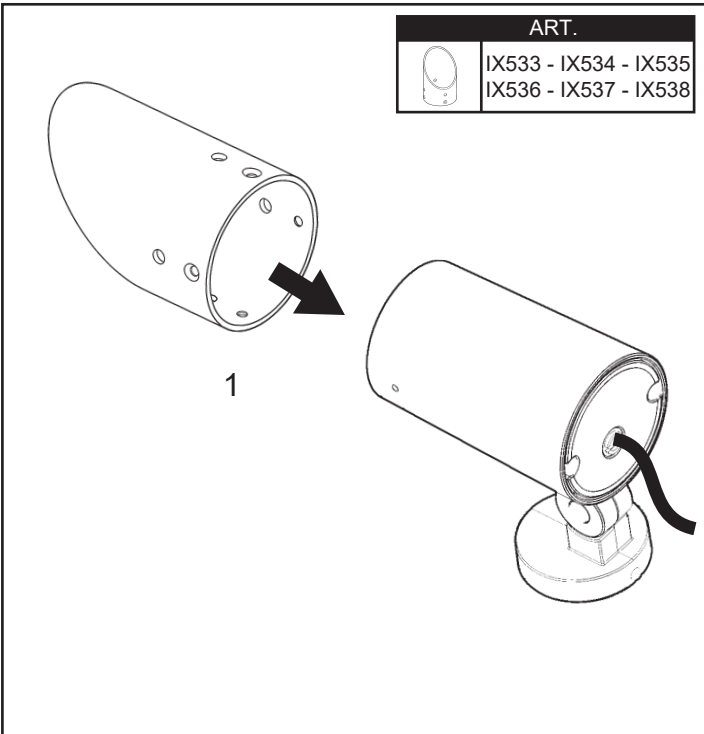
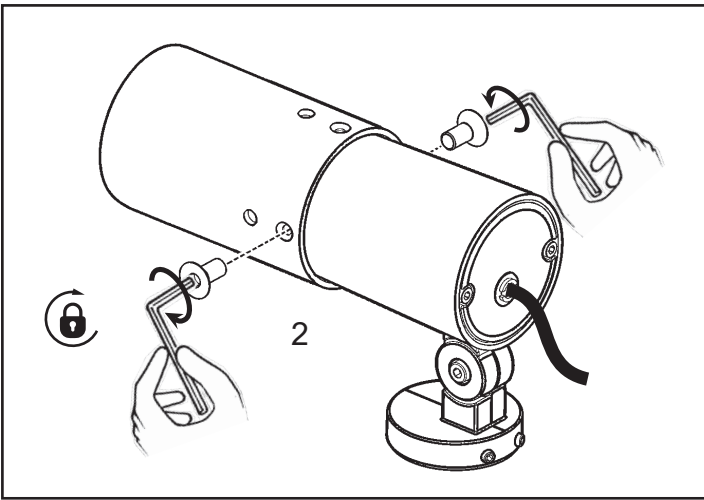

POSITION 1

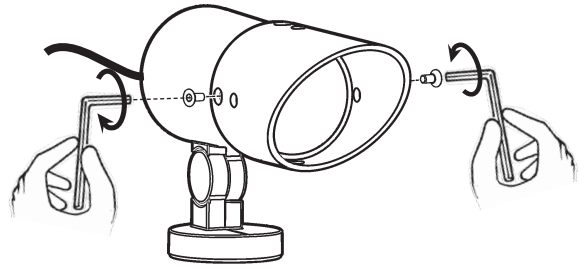

POSITION 2

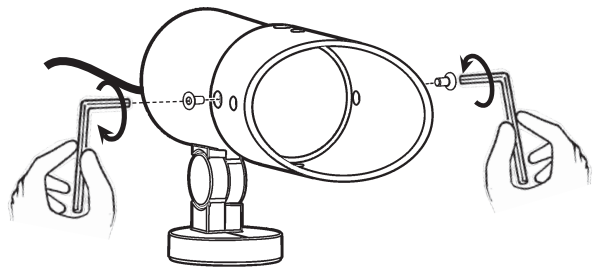

POSITION 3

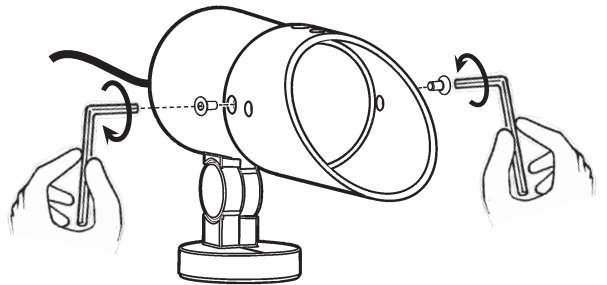

POSITION 4

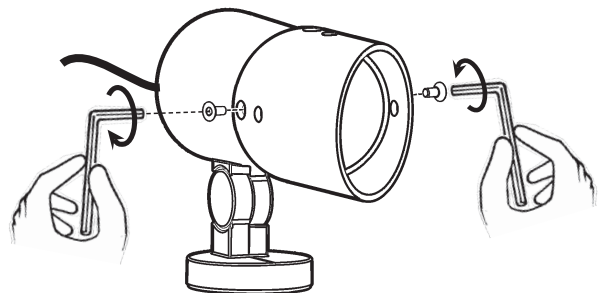

REMOVE MOUNTING PLATE

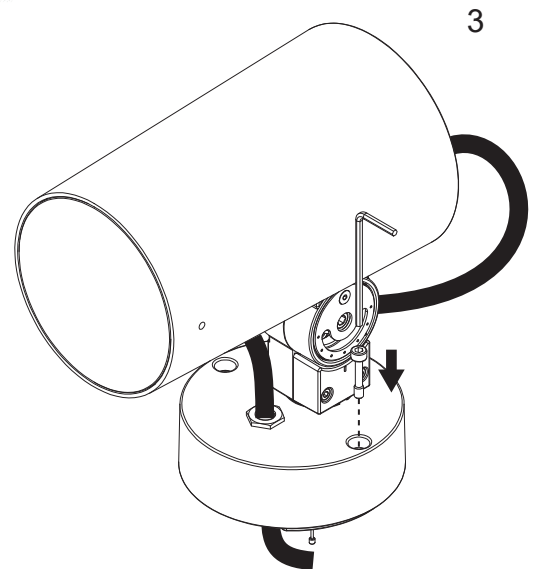
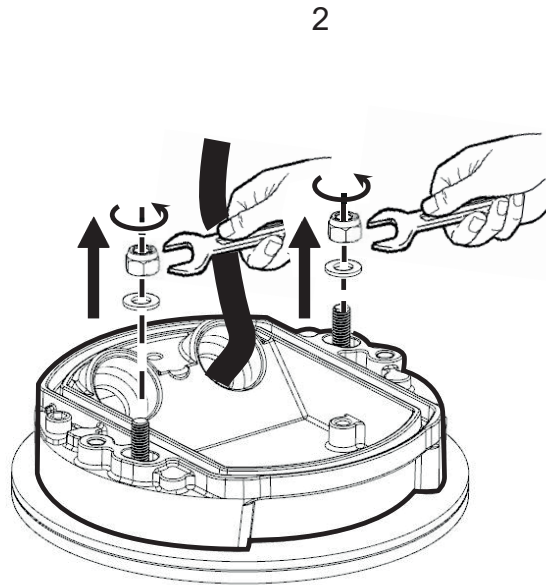
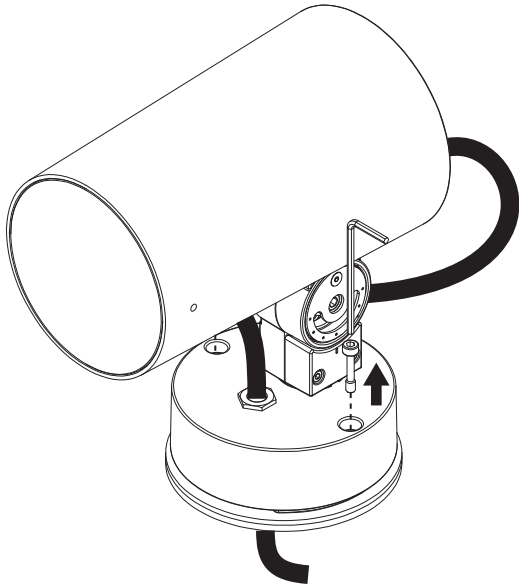

1

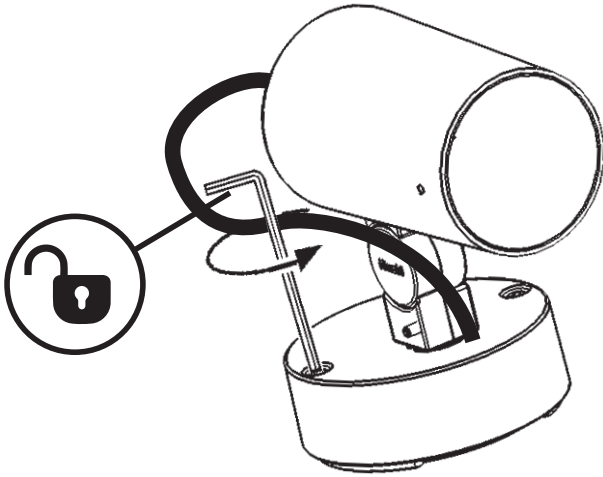

2

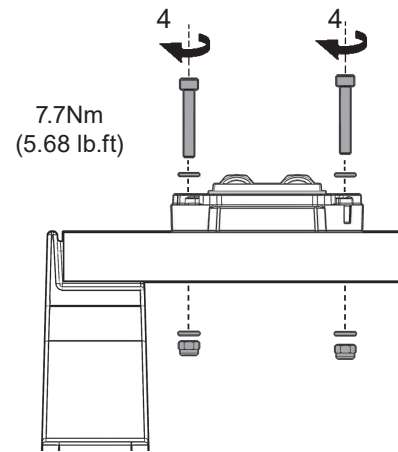
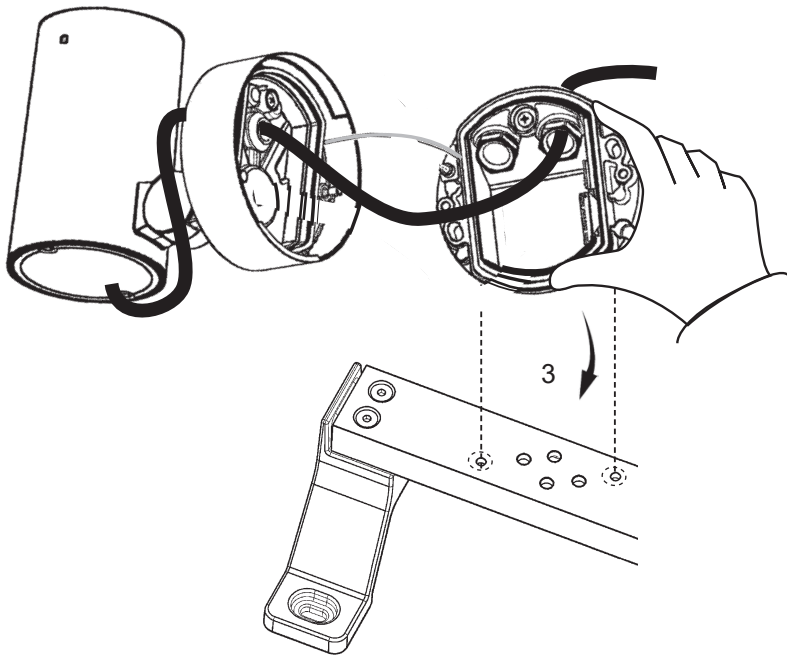
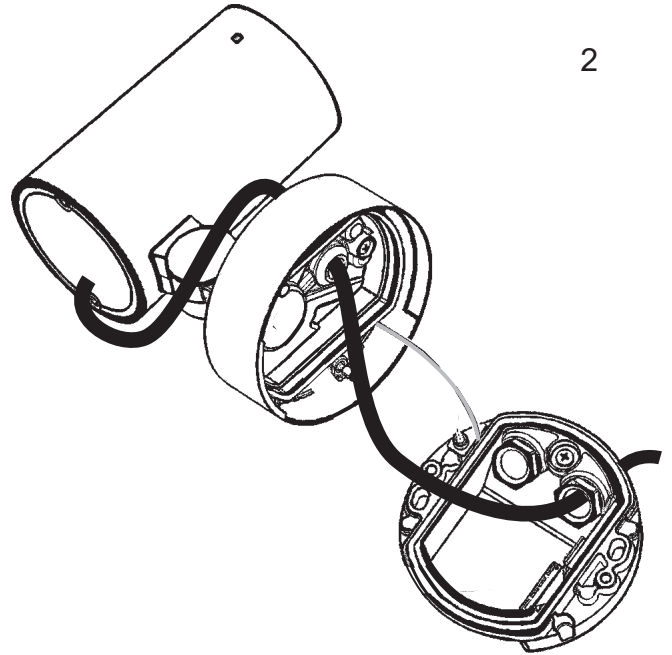

WIRING DIAGRAM

DIMMING 120-277V
0-10V (D10)

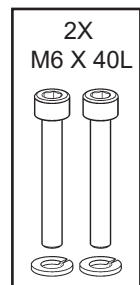
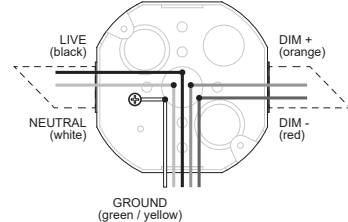

FIXTURE CABLES

**WATERPROOF CONNECTORS
OR
WATERPROOF WIRING BOX**

IX564 (MALE)	IX567
IX565 (FEMALE)	1 MALE INPUT 2 FEMALE OUTPUT

ART.	A in (mm)	B in (mm)	C in (mm)
I6014	9 ¹ / ₄ 236	37 ⁷ / ₈ 962	5 ¹ / ₂ 141
I6015	9 ¹ / ₄ 236	61 ¹ / ₄ 1560	5 ¹ / ₂ 141

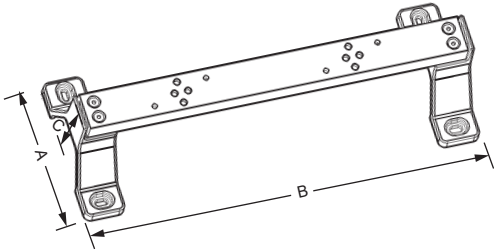

EN All installation positions must comply with those illustrated. In the event of any doubt, contact iGuzzini.

FR Pour les positions d'installation, se conformer aux positions illustrées ; contacter la société iGuzzini en cas de nécessité

ES Respetar las posiciones de instalación ilustradas y, en caso de duda, contactar con iGuzzini
IT Per le posizioni di installazione, attenersi a quelle illustrate, eventualmente contattare la iGuzzini.

I6014-I6015

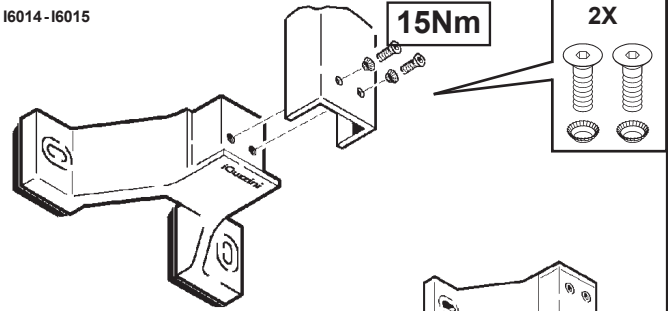

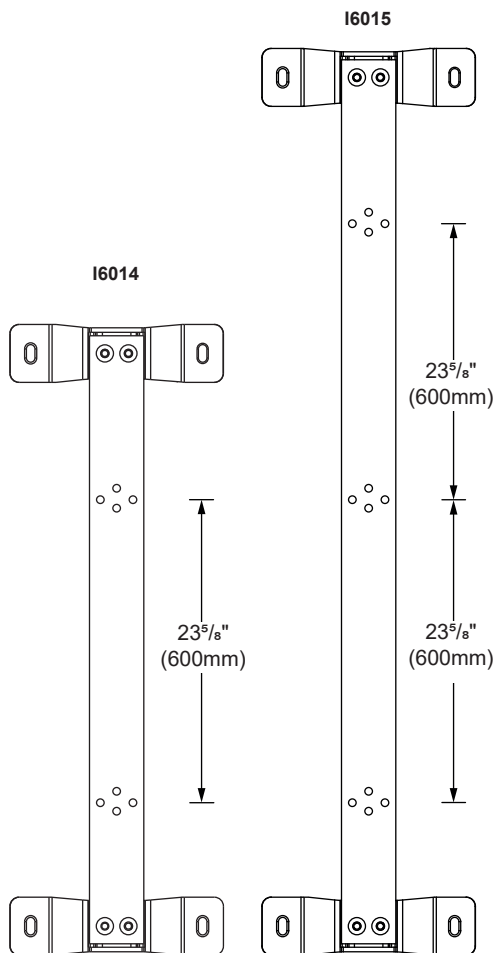
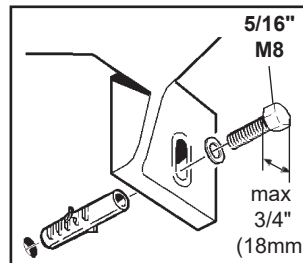
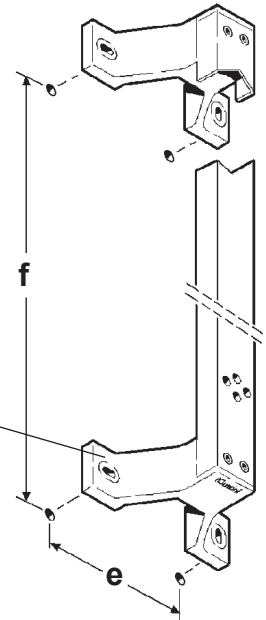

ART.	f in (mm)	e in (mm)
I6014	35 ³ / ₈ (898)	7 ³ / ₈ (190)
I6015	59 (1498)	7 ³ / ₈ (190)

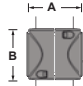

S **M** **L** **X**
SMALL **MEDIUM** **LARGE** **EXTRA LARGE** **POLE MOUNTING ON FLANGE**

- EN** Maximum size, weight and area of the composition complete with accessories.
- FR** Dimensions, poids et surface maximum d'encadrement de la composition avec les accessoires.
- ES** Dimensiones, peso y superficie máxima de ocupación, de la composición completa con accesorios.
- IT** Dimensioni, peso e superficie di massimo ingombro, della composizione con, pletta di accessori.

POLE: Ø4"(102MM)			
ART.	WEIGHT POIDS PESO PESO lb (kg)	DIMENSION / DIMENSION DIMENSION / DIMISIONI a x b inch (mm)	
 IX417	3.75lb (1.6kg)	5 3/4" x 5 1/2" (146 x 140mm)	
 IX419	3.97lb (1.7kg)	6 3/4" x 5 1/2" (151 x 140mm)	

1

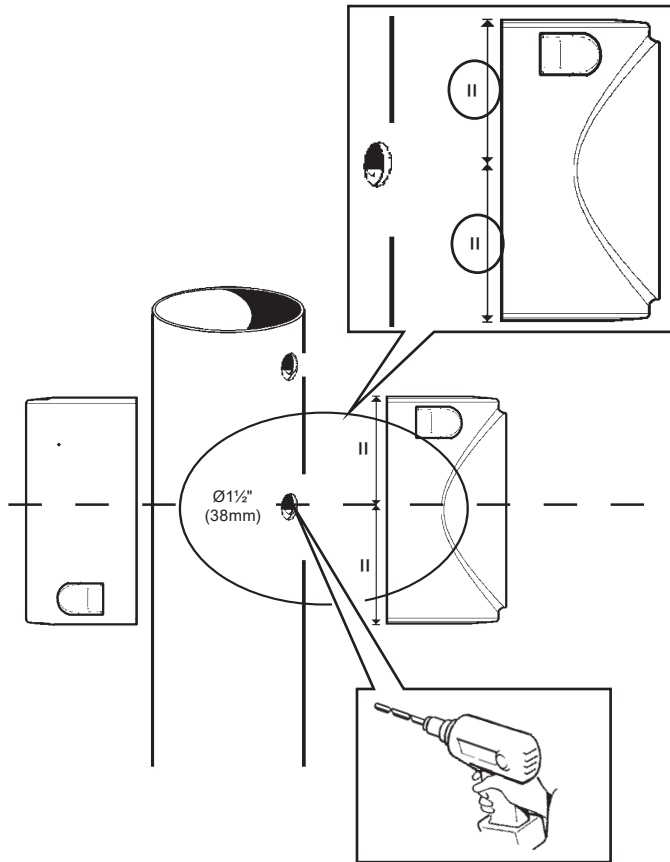

EN Please refer to the instruction sheet for the poles.

FR Consulter la notice d'instructions sur les mâts.

ES Hágase referencia a la hoja de instrucciones de los poste.

IT Fare riferimento al foglio istruzioni dei pali.

P
MIN

2

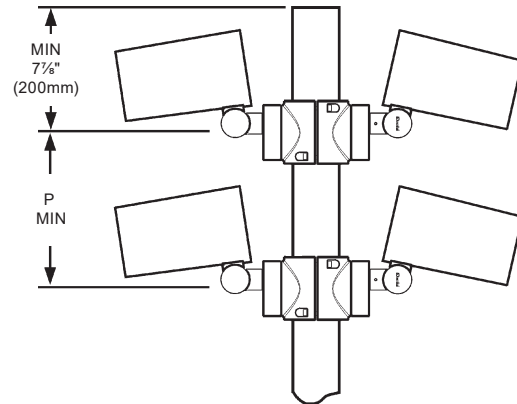
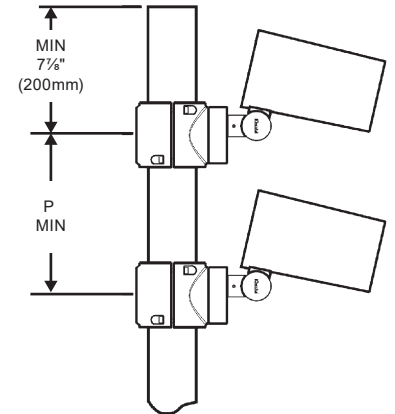

3

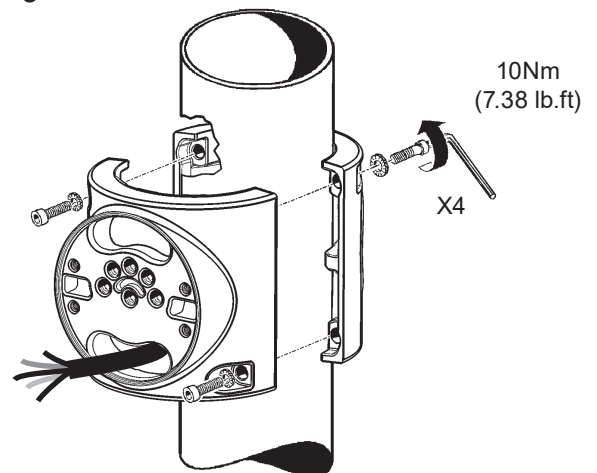

4

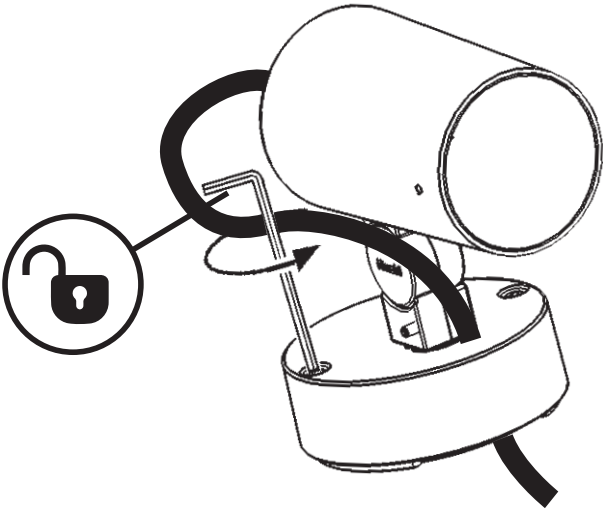

5

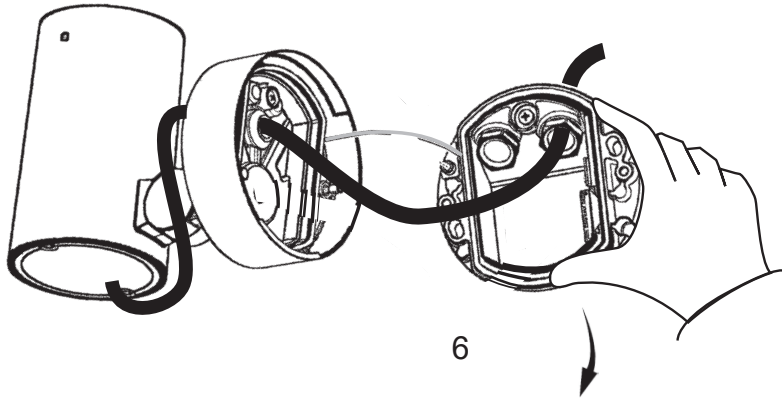
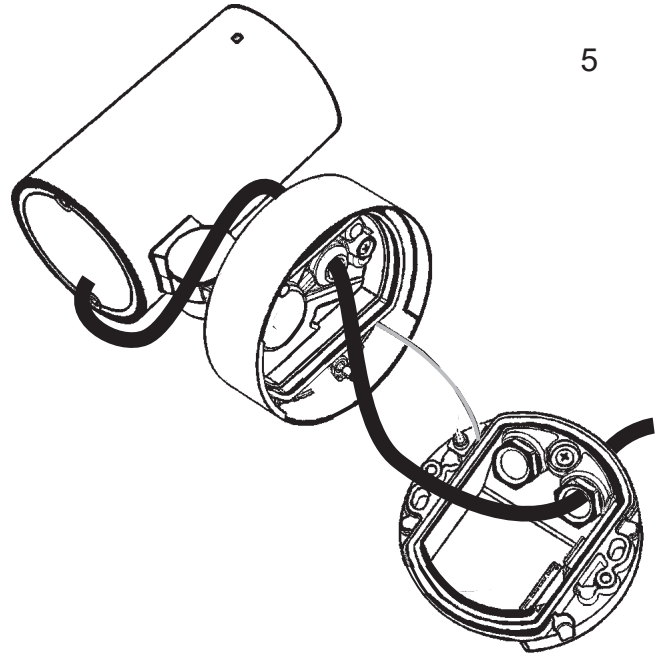

6

OK

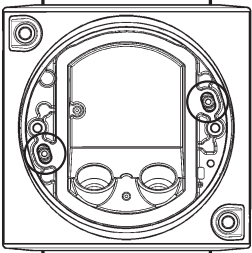

OK

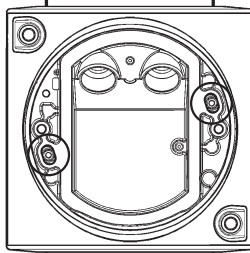

NO

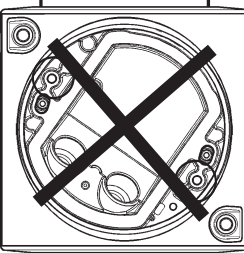

NO

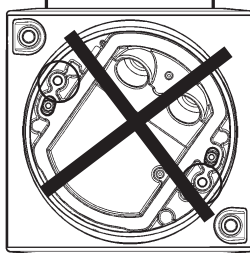

WIRING DIAGRAM

DIMMING 120-277V
0-10V (D10)

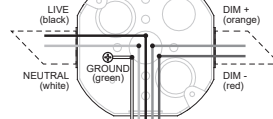

FIXTURE CABLES

5Nm
(3.69lb.ft)

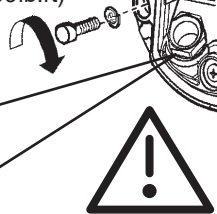

insert into pole
Insérer dans le mât.
insertar en el poste
inserirsi nel post

S SMALL	M MEDIUM	L LARGE	X EXTRA LARGE	ARM POLE MOUNTING
-------------------	--------------------	-------------------	-------------------------	--------------------------

EN Maximum size, weight and area of the composition complete with accessories.
FR Dimensions, poids et surface maximum d'encombrement de la composition avec les accessoires.
ES Dimensiones, peso y superficie máxima de ocupación, de la composición completa con accesorios.
IT Dimensioni, peso e superficie di massimo ingombro, della composizione completa con accessori.

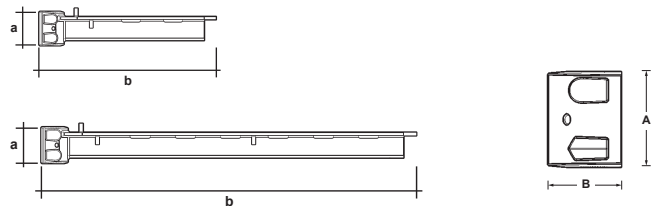

MODELS	WEIGHT POIDS PESO lb (kg)	DIMENSION / DIMENSION DIMENSION / DIMISIONI a x b inch (mm)
IX568	11.11lb (5.04kg)	3 1/2" x 19 1/4" (90 x 488mm)
IX570	18.14lb (8.23kg)	3 1/2" x 37 1/4" (90 x 946mm)
I6161	4.76lb (2.16kg)	3 1/2" x 2 3/4" (90 x 68mm)

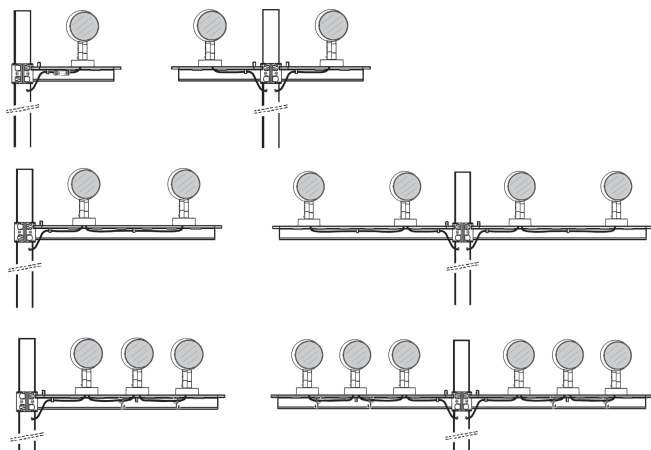

MULTIPLE CONNECTION

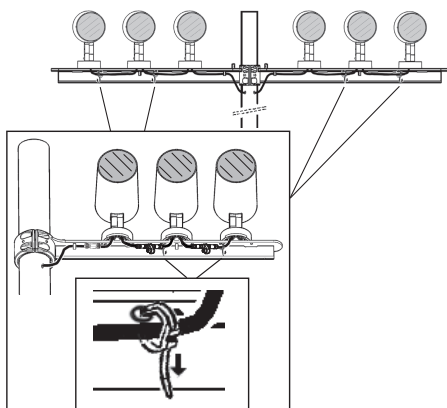

MAT - POLE POSTE - PALO

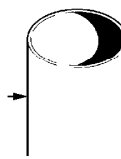

art. I6161	+	art. IX568
art. I6161	+	art. IX570
art. IX568	+	art. IX568
art. IX570	+	art. IX570
art. IX570	+	art. IX568

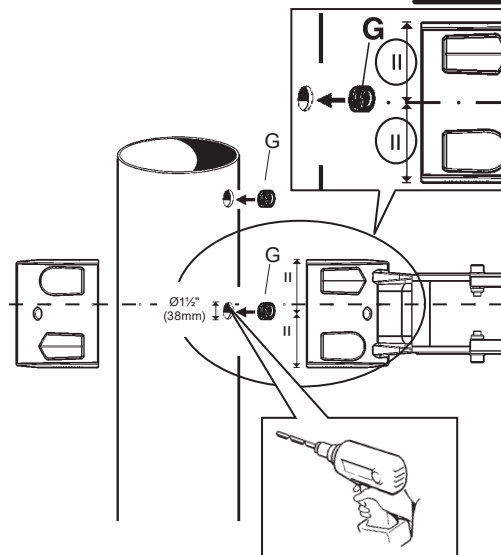
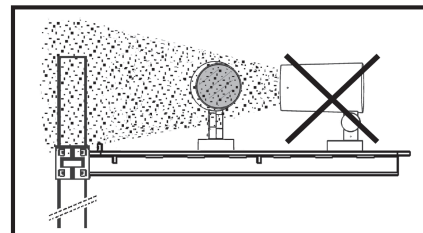

EN Please refer to the pole instruction sheet for the arm positions on the pole.
FR Pour le positionnement des bras sur le mât, veuillez consulter la notice des mâts.
ES Para colocar los brazos en el poste, consultar la hoja de instrucciones de los postes.
IT Per il posizionamento dei bracci sul palo, fare riferimento al foglio istruzioni dei pali.

EN When installing the compositions with the greatest number old products (max number), in some case you need to drill holes into the poles and to apply the rubber elements "G" supplied in the package.
FR Pour l'installation de la composition ayant le plus grand nombre d'appareils.(max) percer sur les mâts les trous manquants et mettre dans les trous les passes-fils de caoutchoucs "G" fournis dans l'emballage.
ES En las instalaciones de las composiciones con el máximo número de productos (N.máx), en algunos casos se necesita realizar las perforaciones que faltan en los postes y aplicar las gomas "G" incluidas en el embalaje.
IT Nelle installazioni delle composizioni con il maggior numero di prodotti (N° max), in alcuni caso pccorre praticare sui pali i fori mancanti ed applicare i gommini "G" inclusi nell'imballo.

EN Break the membrane only on the holes used for passing through the cables.
FR Ne défoncer que la membrane des trous utilisés pour le passage des câbles.
ES Rasfar la membrana únicamente en el lugar donde han de pasar los cables.
IT Sfondare la membrana soltanto sui fori utilizzati per il passaggio dei cavi.

2

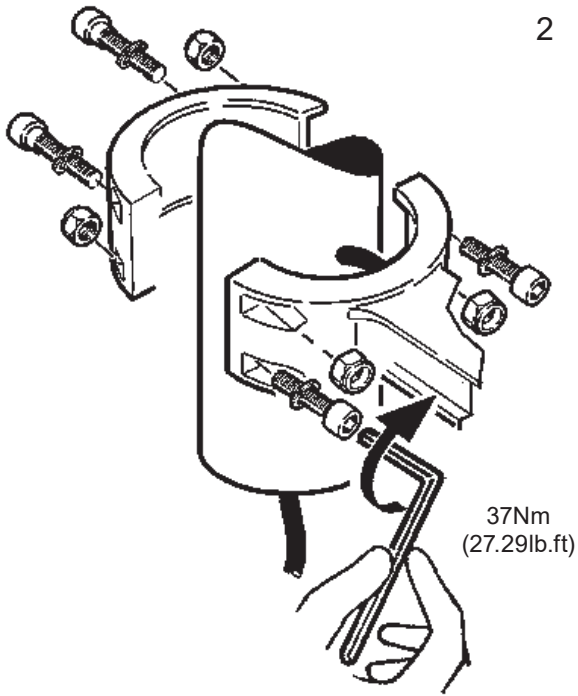

4

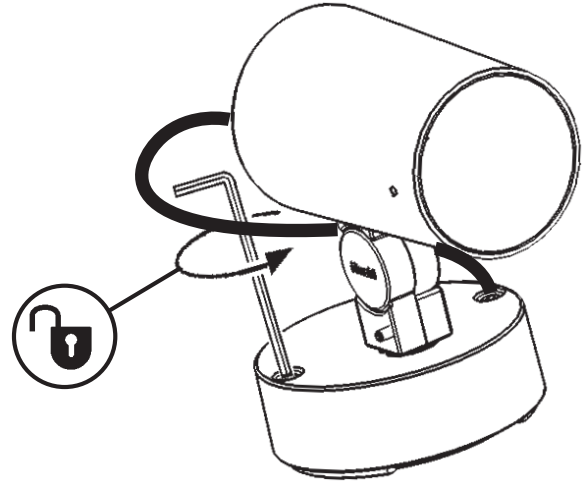

3

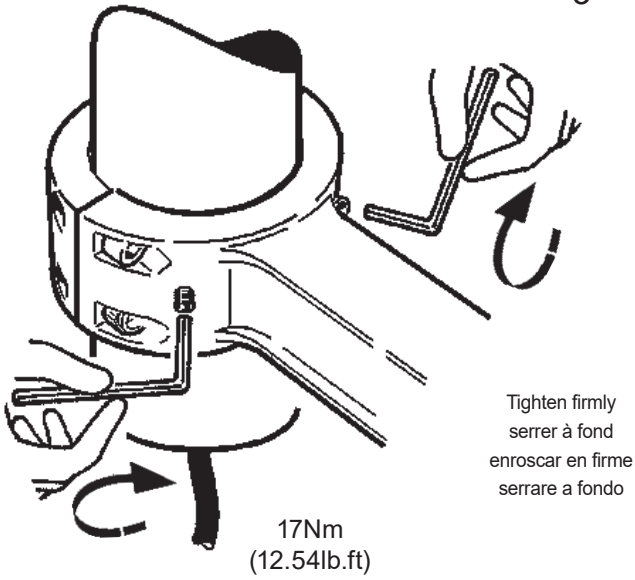

5

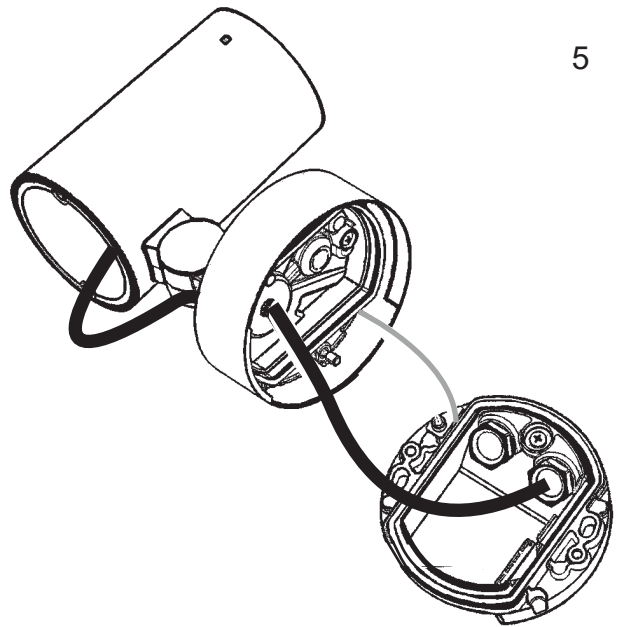

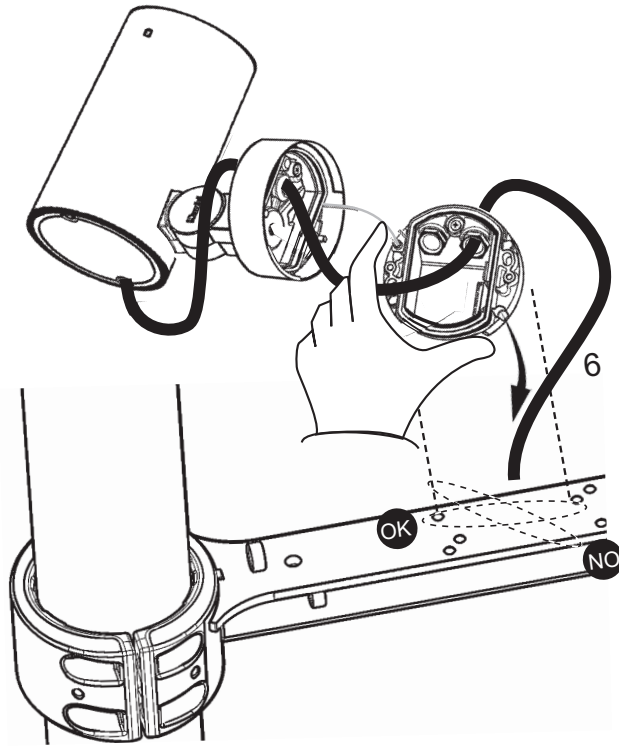
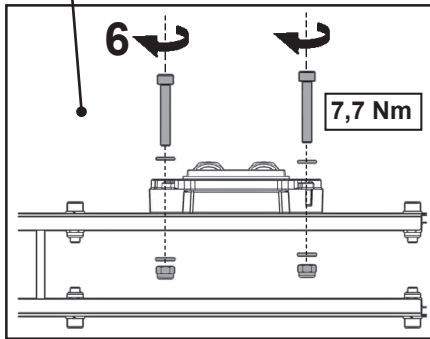
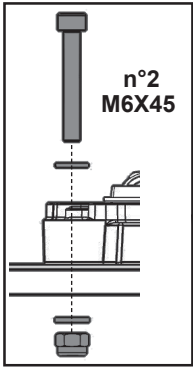

M
MEDIUM

SINGLE CONNECTION

WIRING DIAGRAM
DIMMING 0-10V (D10)
120V, 120-277V

FIXTURE CABLES

A

WATERPROOF CONNECTORS OR WATERPROOF WIRING BOX

IX565 (FEMALE)	BY OTHERS
IX564 (MALE)	

B

M
MEDIUM

MULTIPLE CONNECTIONS

WIRING DIAGRAM
DIMMING 0-10V (D10)
120V, 120-277V

FIXTURE CABLES

A

WATERPROOF CONNECTORS OR WATERPROOF WIRING BOX

IX567	BY OTHERS
IX565 (FEMALE)	
IX564 (MALE)	
IX2	

B

SPIKE

C
MICRO

N
MINI

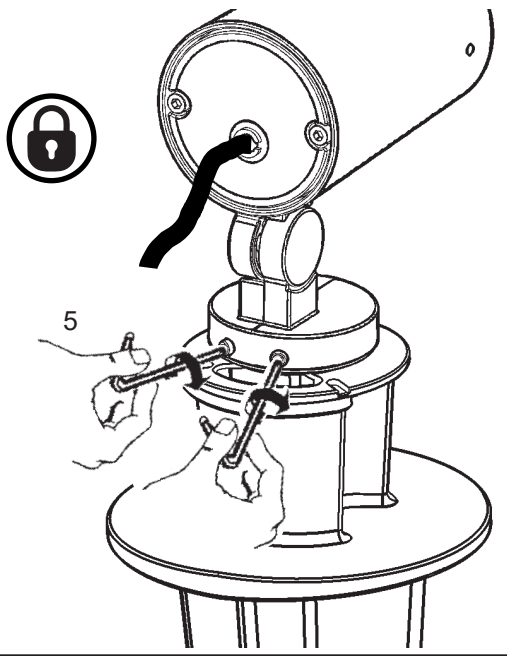
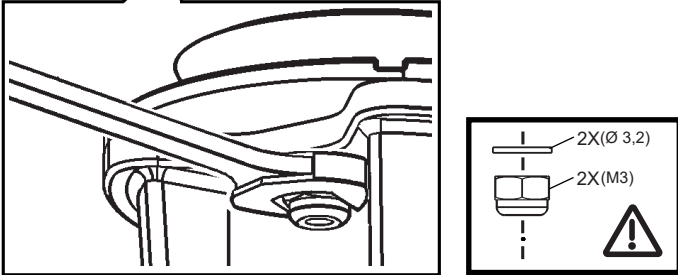
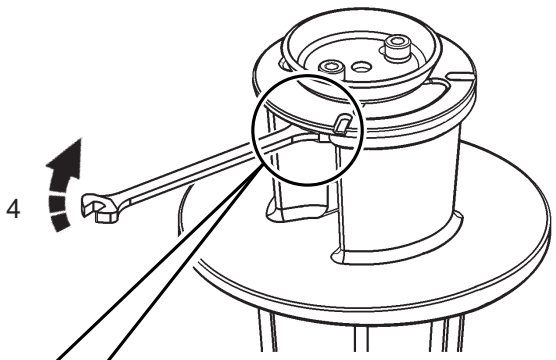
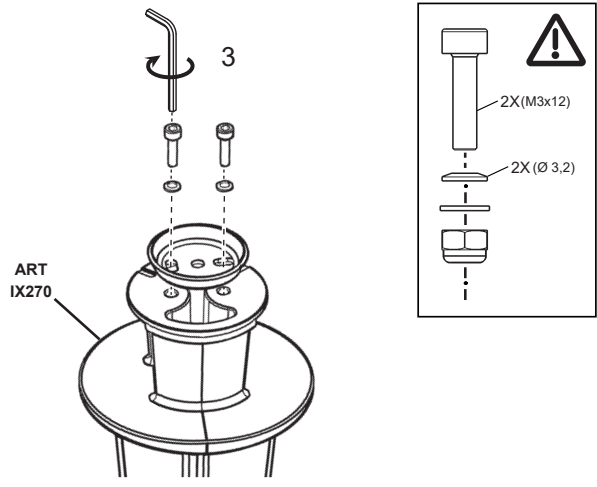
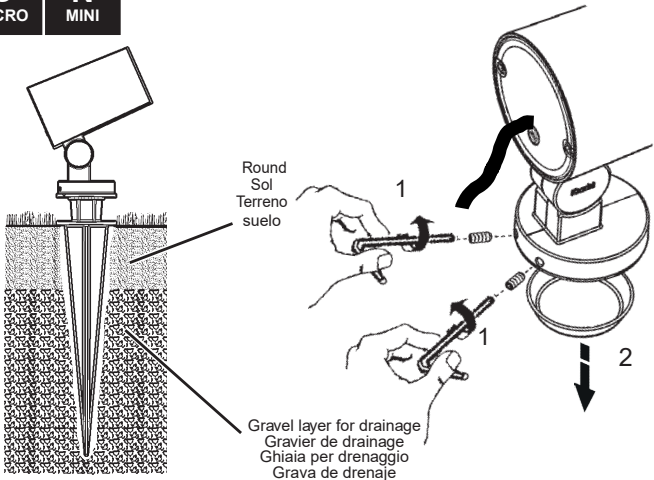

S*
SMALL

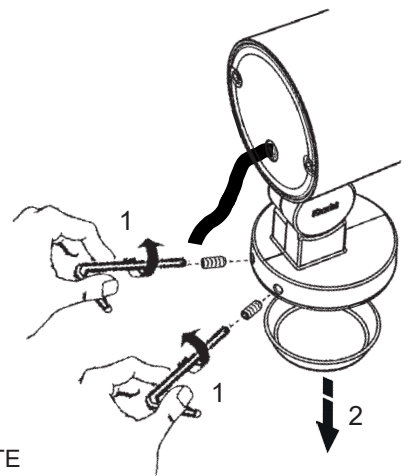

*REMOTE

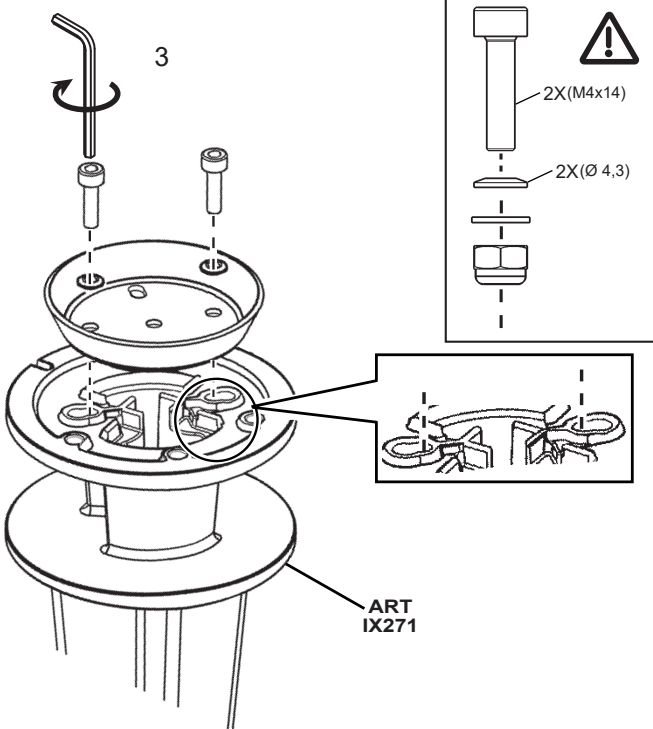

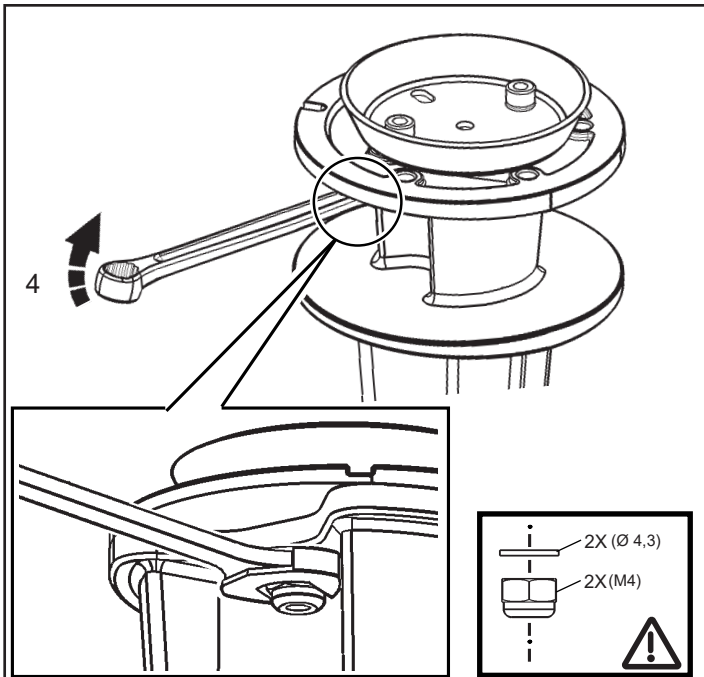

LED +	RED
LED -	BLACK

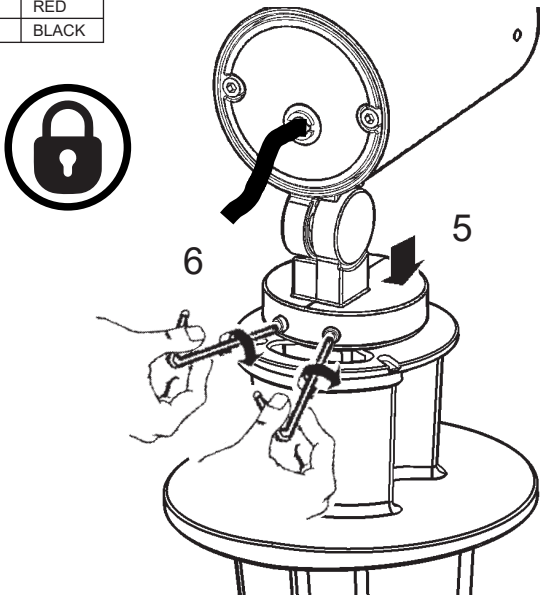

S** M
SMALL MEDIUM

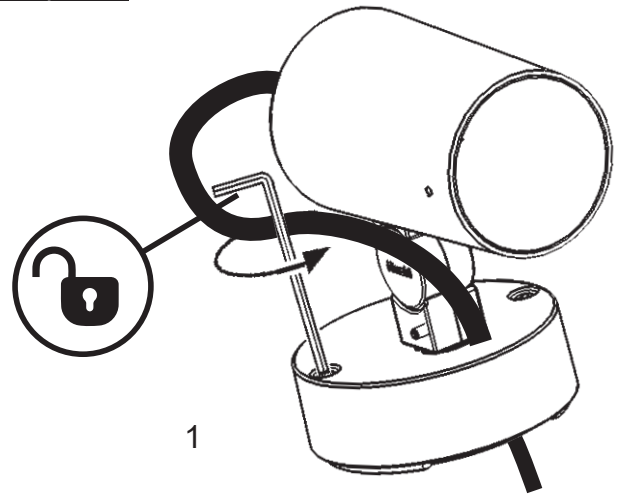

**INTEGRAL

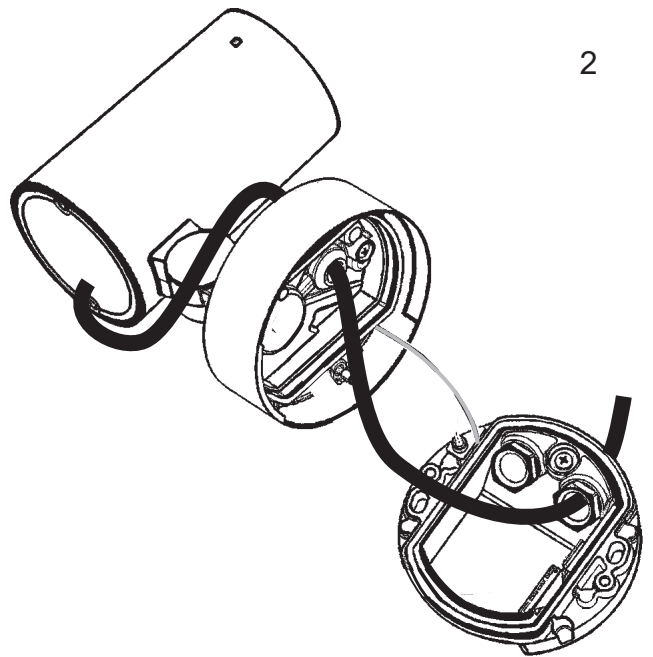

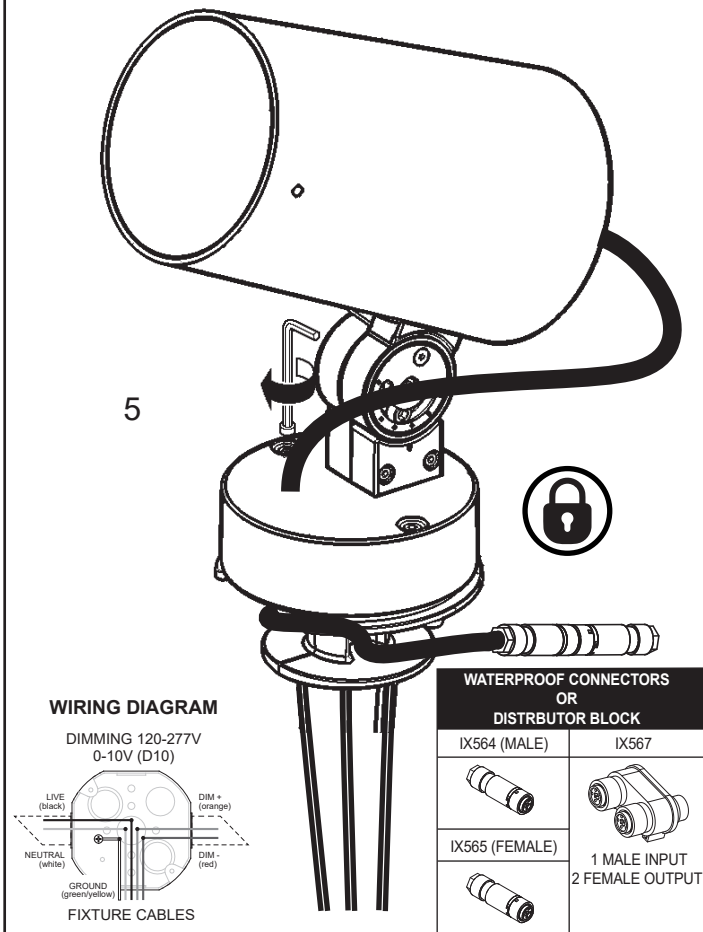
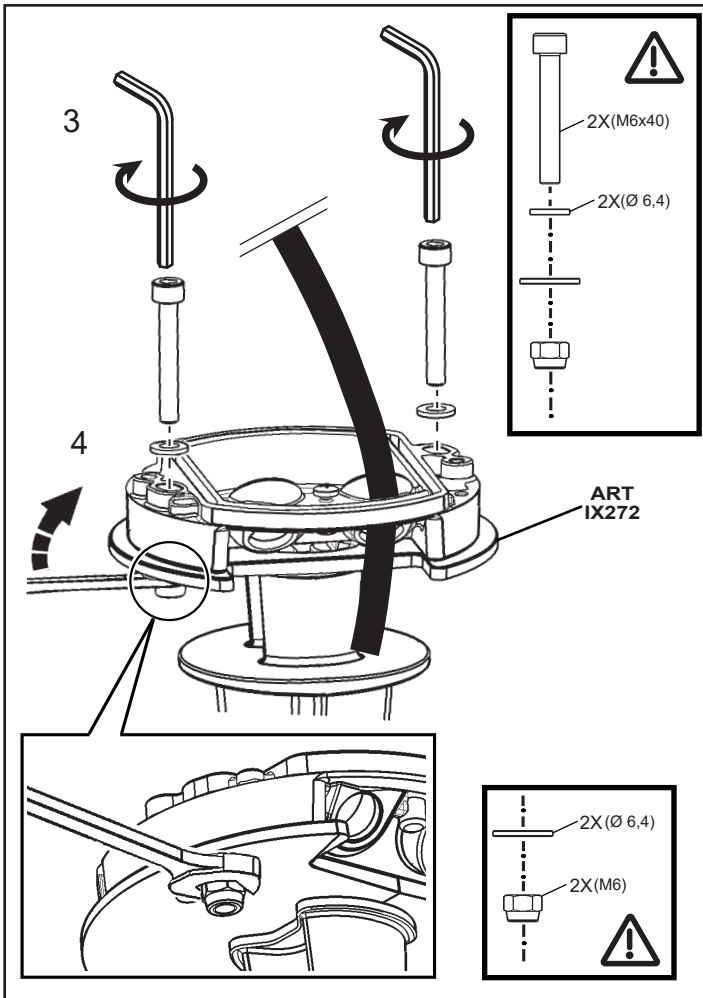

EN N.B.: For information on LED replacement please contact iGuzzini.
 FR N.B.: Pour procéder au remplacement de la LED, adressez-vous à la société iGuzzini.
 ES NOTA: Para sustituir el LED llame a la empresa iGuzzini.
 IT N.B.: Per la sostituzione del LED contattare l'azienda iGuzzini.

EN Should the lenses break, the product cannot be used. Contact the manufacturer for replacement.
 FR En cas de rupture des lentilles, le produit ne peut plus être utilisé. Contacter le fabricant pour procéder à son remplacement.
 ES En caso de rotura de las lentes, el producto no puede utilizarse y se debe contactar con el fabricante para su sustitución.
 IT In caso di rottura delle lenti il prodotto non può essere utilizzato, contattare il costruttore per la sua sostituzione.